

SUBLINE350/350U, SUBLINE350/350UG, SUBLINE350/350UW

BLANCO



Model Code

SUBLINE350/350U - Anthracite
SUBLINE350/350UG - Rock grey
SUBLINE350/350UW - White

Description

Double bowl undermount sink

Optional Accessories

SUBLINEBK BDRAINP ANDCUTGCB
SUBLINECOLSS BWCB CAPFLOW

Warranty

30 year warranty



Hygiene+Plus

Features

Engineered In Germany

Durability

Hygiene + Plus™

Maximum Bowl Size

Designer Wastes

Rear Waste Position

Benefits

Elegant SILGRANIT™ design impresses with its timeless, straight lined bowl geometry which will suit all types of kitchen products and worktops.

SILGRANIT™ PuraDur™ consists of 80% granite, which makes it unbeatably resilient, extremely durable, scratch resistant, heat resistant, unbreakable and acid resistant.

A patented formula that acts as a shield against dirt and bacteria. This hygiene protection reduces bacteria growth by an average of 98%.

Due to the smallest possible radii of 10mm it allows for a large sink area and a modern classy look.

No additional costs after purchase.

Increases your storage space below the sink.



Specifications

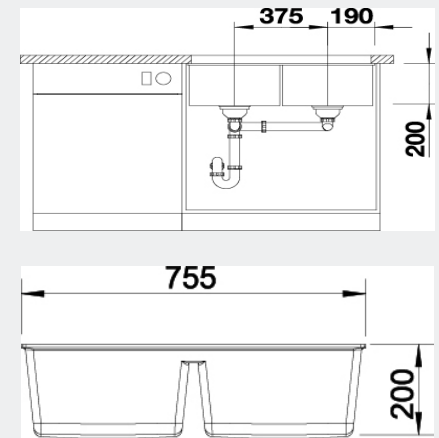
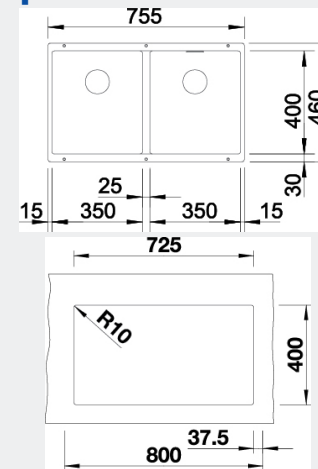

Method of Installation:

Undermount

Cabinet size:

80cm cabinet

Overall Dimensions:

755w x 460d x 200/200hmm

Cut-out Dimensions:
website for corner radii)

725w x 400d (refer to CAD drawing on the

Colour:

Available in Anthracite, Rock grey, White

Bowl Capacities:

26 Litres

Standard Inclusion:

Designer Wastes

Integrated Overflow:

Yes

Warranty:

30 years

Note: Measurements are within 2 - 3mm of factory tolerance. It is advisable to check dimensions of physical product when measuring for installations and before doing any cut outs.

*Due to continual product development the information provided is not final and may be subject to change.