

Ceramic Cooktops  
User and Installation Manual

A black and white photograph of a wooden cutting board. On the board, there is a large piece of meat, possibly a roast or brisket, with a fork stuck into it. Several sprigs of rosemary are scattered around the meat. There are also some small piles of what appears to be salt or seasoning on the board. The background is a dark, textured surface, possibly a wooden table.

**MODELS**

CHC644BA, CHC744BA, CHC944BA,  
SHC644BA, SHC944BA

# general safety

## CONGRATULATIONS

Congratulations and thank you for choosing our Ceramic Cooktop. We are sure you will find your new appliance a pleasure to use and a great asset to your cooking. Before you use the appliance, we recommend that you read through the whole user manual which provides a description of the product and its functions.

To avoid the risks that are always present when you use a cooking appliance, it is important that the appliance is installed correctly and that you read the safety instructions carefully to avoid misuse and hazards. For future reference, please store this booklet in a safe place. This appliance complies to the requirements of Australian Standard AS4551.

## CONDITIONS OF USE

This appliance is intended to be used in household and similar applications such as:

- Staff kitchen areas in shops, offices and other working environments
- Farm houses
- By clients in hotels, motels and other residential type environments
- Bed and breakfast type environments

### Record model and serial number here:

Model: .....

Serial number: .....

The symbols you will see in this booklet have these meanings:



### warning

Indicates information concerning your personal safety



### caution

Indicates information on how to avoid damaging the appliance



### tips & information

Indicates tips and information about use of the appliance



### environmental tips

Indicates tips and information about economical and ecological use of the appliance



### tips & information

#### Important – check for any damage or marks

If you find the appliance is damaged or marked, you must report it within 7 days if you wish to claim for damage/marks under the manufacturer's warranty. This does not affect your statutory rights.



### environmental tips

#### Information on disposal for users

- Most of the packing materials are recyclable. Please dispose of those materials by contacting your local authorities and ask for the correct method of disposal.

## CONTENTS

<b>Safety instructions</b> .....	<b>4</b>
<b>Description of the Appliance</b> .....	<b>6</b>
<b>Operating the appliance</b> .....	<b>8</b>
<b>Tips on Cooking and Frying</b> .....	<b>9</b>
<b>Cleaning and Care</b> .....	<b>11</b>
<b>What to do if</b> .....	<b>13</b>
<b>Disposal</b> .....	<b>14</b>
<b>Technical Data</b> .....	<b>15</b>
<b>Installation Instructions</b> .....	<b>16</b>
<b>Assembly</b> .....	<b>18</b>
<b>Guarantee/Customer Service</b> .....	<b>23</b>
<b>Service</b> .....	<b>25</b>

**Please comply with these instructions. If you do not, any damage resulting is not covered by the warranty.**

### General safety

- This appliance may only be installed and connected by trained, registered service engineers.
- Built-in appliances may only be used after they have built-in units and work surfaces that meet standards.
- In the event of faults with the appliance or damage to the glass ceramic (cracks, scratches or splits), the appliance must be switched off and disconnected from the electrical supply, to prevent the possibility of an electric shock.
- Repairs to the appliance must only be carried out by trained registered service engineers.

### Children's safety

- The cooking zones will become hot when you cook. Therefore, always keep small children away from the appliance.
- The appliance is not intended for use by persons (including children) with reduced physical, sensory or mental capabilities, or lack of experience and knowledge, unless they have been given supervision or instruction concerning use of the appliance by a person responsible for their safety.
- Children should be supervised to ensure that they do not play with the appliance.

### Correct use

- This appliance should be used only for normal domestic cooking and frying of food.
- The appliance must not be used as a work surface or as a storage surface.
- Additions or modifications to the appliance are not permitted.
- Do not place or store flammable liquids, highly inflammable materials or fusible objects (e.g. plastic film, plastic, aluminium) on or near the appliance.

### Safety during use

- Remove stickers and film from the glass ceramic.
- There is the risk of burns from the appliance if used carelessly.
- Cables from electrical appliances must not touch the hot surfaces of the appliance or hot cookware.
- Overheated fats and oils can ignite very quickly. When cooking with fat or oil (e.g. Chips) do not leave the appliance unattended.
- Switch the cooking zones off after each use.

### Safety when cleaning

- For cleaning, the appliance must be switched off and cooled down.
- For safety reasons, the cleaning of the appliance with steam jet or high pressure cleaning equipment is not permitted.

### How to avoid damage to the appliance

- The glass ceramic can be damaged by objects falling onto it.
- The edge of the glass ceramic can be damaged by being knocked by the cookware.
- Cookware made of cast iron, cast aluminum or with damaged bottoms can scratch the glass ceramic if pushed across the surface.
- Objects that melt and things that boil over can burn onto the glass ceramic and should be removed straightaway.
- To avoid damaging cookware and glass ceramics, do not allow saucepans or frying pans to boil dry.
- Do not use the cooking zones with empty cookware or without cookware.

# description

## Cooking surface layout

**CHC644BA / CHC744BA / SHC644BA**

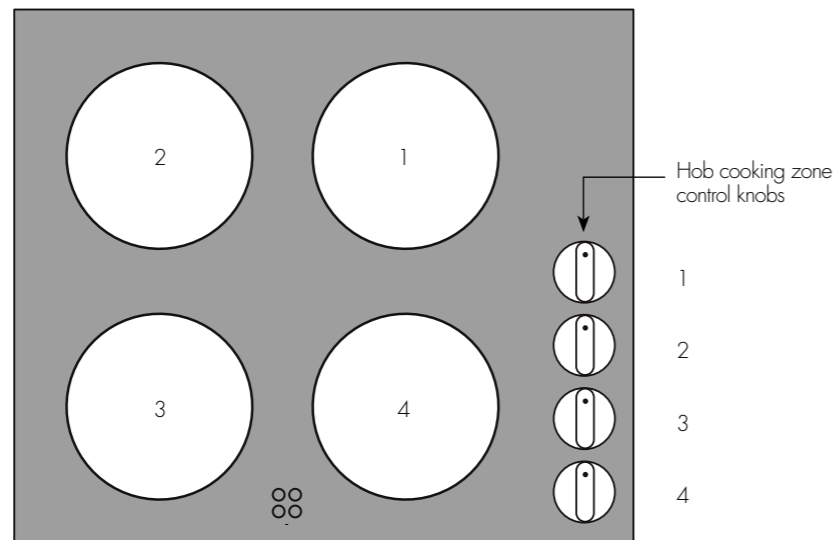

**CHC944BA / SHC944BA**

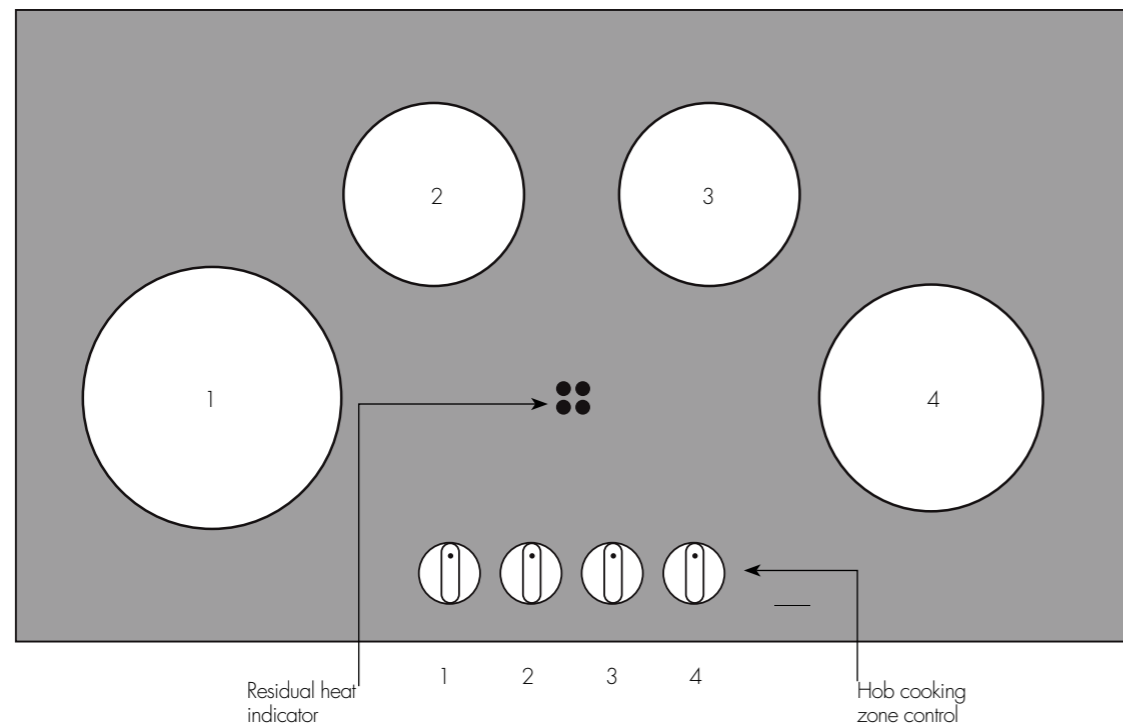

# description

## Control knobs

The cooking power can be set anywhere between level LO and HI.

LO	Lowest power
HI	Higest
○	Off position

## Residual heat indicator

The residual heat indicator lights up, as soon as the corresponding zone is hot.

## warning

Risk of burns from residual heat. After being switched off, the cooking zones need some time to cool down. Look at the residual heat indicator.

## environmental tips

Residual heat can be used for melting and keeping food warm.

# operating the appliance

## tips & information

When a cooking zone is switched on, it may hum briefly. This is a characteristic of all ceramic glass cooking zones and does not impair either the function or the life of the appliance.

## Setting the heat setting

The residual heat indicator lights up, as soon as the corresponding zone is hot.

HEAT SETTING	RING CONTROL KNOB	KNOB SETTING
To increase	Turn clockwise	Low – High
To decrease	Turn anti-clockwise	Low – High
Switch off	Off	

1. When boiling water/searing food, select a high heat setting.
2. As soon as steam forms or the fat or oil is hot, set a lower heat setting.
3. To end the cooking process, turn to the off position.

# cooking and frying

## **i** tips & information

According to the latest scientific knowledge, intensive browning of food, especially in products containing starch, can constitute a health risk due to acrylamides. Therefore we recommend cooking at the lowest possible temperatures and not browning foods too much.

## **Cookware**

The residual heat indicator lights up, as soon as the corresponding zone is hot.

# energy saving

## **🌿** environmental tips

Always place cookware on the cooking zone before it is switched on.

If possible, always place lids on the pans.

Switch cooking zones off before the end of the cooking time, to take advantage of residual heat.

Bottom of pans and cooking zones should be the same size.

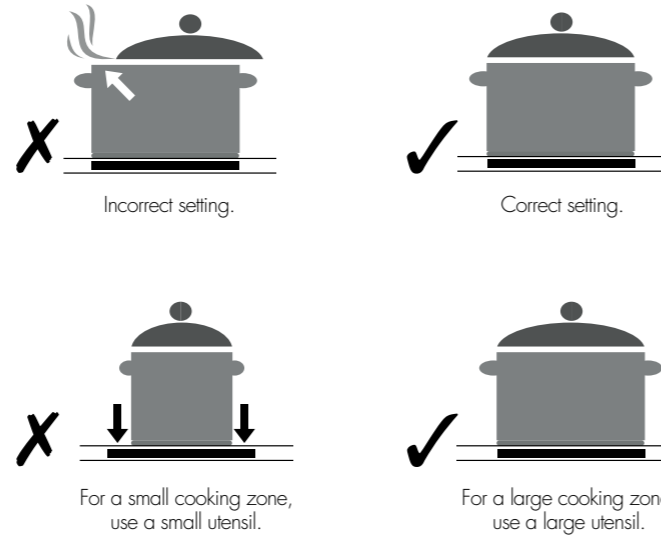

# cleaning and care

## **⚠** warning

Risk of burns from residual heat.

## **⚠** warning

Sharp objects and abrasive cleaning materials will damage the appliance. Clean with water and washing up liquid.

## **⚠** warning

Residues from cleaning agents will damage the appliance. Remove residues with water and washing up liquid.

## **Cleaning the appliance after each use**

1. Wipe the appliance with a damp cloth and a little washing up liquid.
2. Rub the appliance dry using a clean cloth.

## **Removing deposits**

1. Place a scraper on the glass ceramic surface at an angle.
2. Remove residues by sliding the blade over the surface.
3. Wipe the appliance with a damp cloth and a little washing up liquid.
4. Rub the appliance dry using a clean cloth.

TYPE	REMOVE			
	IMMEDIATELY	AFTER COOLING	USE	
Sugar, food containing sugar	yes	–		a scraper*
Plastics, tin foil	yes	–		a scraper*
Limescale and water rings	–	yes		cleaner for glass ceramic or stainless steel*
Fat splashes	–	yes		cleaner for glass ceramic or stainless steel
Shiny metallic discolouration	–	yes		cleaner for glass ceramic or stainless steel

\* Scrapers and cleaners for glass and stainless steel can be purchased in specialist shops.

## **i** tips & information

Remove stubborn residues with a cleaner for glass ceramic or stainless steel.

Scratches or dark stains on the glass ceramic that cannot be removed do not however affect the functioning of the appliance.

# troubleshooting

PROBLEM	POSSIBLE CAUSE	REMEDY
The cooking zones are not functioning.	The desired heat setting is not set.	Set the heat setting.
	The fuse in the house's electrical wiring (fuse box) has been tripped.	Check the fuse. If the fuses trip a number of times, please call an authorised electrician.
The residual heat indicator is not displaying anything.	The cooking zone was only on for a short time and is therefore not hot.	If the cooking zone is supposed to be hot, call the customer service department.

If you are unable to remedy the problem by following the above suggestions, please contact your dealer or the customer service department.



## warning

Repairs to the appliance are only to be carried out by qualified service engineers. Considerable danger to the user may result from improper repairs.



## tips & information

If the appliance has been wrongly operated, the visit from the customer service technician or dealer may not take place free of charge, even during the warranty period.

# disposal



## environmental tips

### Packaging material

The packaging materials are environmentally friendly and can be recycled. The plastic components are identified by markings e.g. >PE<, >PS<, etc. Please dispose of the packaging materials in the appropriate container at the community waste disposal facilities.



## environmental tips

### Old appliance

The symbol  on the product or on its packaging indicates that this product may not be treated as household waste. Instead it shall be handed over to the applicable collection point for the recycling of electrical and electronic equipment. By ensuring this product disposed of correctly, you will help prevent potential negative consequences for the environment and human health, which could otherwise be caused by inappropriate waste handling of this product, please contact your local city office, your household waste disposal service of the shop where you purchased the product.

# technical data

MODEL	CHC644BA / SHC644BA		CHC744BA		CHC944BA / SHC944BA	
PNC	949 163 312 / 949 163 317		949 163 313		949 163 314 / 949 163 316	
Product dimensions (w x d) mm	610 x 515		700 x 520		930 x 520	
Cut-out dimensions (w x d) mm	560 x 490 (485)		560 x 490 (485)		880 x 490 (485)	
Voltage (volts)	230		230		230	
Cycles (Hz)	50		50		50	
Service cord	not fitted		not fitted		not fitted	
Elements	No. zones	Watts	No. zones	Watts	No. zones	Watts
front left	1	1800	1	1800	1	2300
Rear left	1	1200	1	1200	1	1200
Front right	1	1200	1	1200	1	1800
Rear right	1	1800	1	1800	1	1200
Total		6000		6000		6500



# installation

## Safety instructions

The laws, ordinances, directives and standards in force in the country of use are to be followed (safety regulations, proper recycling in accordance with the regulations, etc.)

Installation may only be carried out by a qualified electrician. The minimum distances to other appliances and units are to be observed. Anti-shock protection must be provided by the installation, for example drawers may only be installed with a protective floor directly underneath the appliance. The cut surfaces of the workshop are to be protected against moisture using a suitable sealant. The sealant seals the appliance to the worktop with no gap. Avoid installing the appliance next to doors and under windows. Otherwise hot cookware may be knocked off the rings when doors are opened.

## ⚠ warning

Risk of injury from electrical current.

- The electrical mains terminal is live.
- Make electrical mains terminal free of voltage.
- Observe connection schematic.
- Observe electrical safety rules.
- Ensure anti-shock protection through correct installation by a qualified electrician.
- The appliance must be connected to the electrical supply by a qualified electrician.

## ⚠ warning

Risk of injury from electrical current.

Loose and inappropriate plug and socket connections can make the terminal overheat.

- Have the clamping joints correctly installed by a qualified electrician.
- Use strain relief clamp on cable.
- CAUTION: The surface temperature exceeds 95°C. To avoid a hazard, underbench access must be restricted.
- Supply cords must have a temperature rating not less than 105°C.

# electrical connection

Before connecting, check that the nominal voltage of the appliance, that is the voltage stated on the rating plate, corresponds to the available supply voltage.

The rating plate is located on the lower casting of the hob.

The heating element voltage is AC230V~. The appliance also works perfectly on networks with AC220V~ or AC240V~.

The hob is to be connected to the mains using a device that allows the appliance to be disconnected from the mains at all poles with a contact opening width of at least 3mm, e.g. automatic line protecting cut-out, earth leakage trips or fuse. A cable with minimum temperature rating of V90HT or one with a higher grade must be used as the mains connecting cable. The connection must be carried out as shown in the diagram. The connecting links should be fitted according to the appropriate connection diagram. The earth lead must be longer than leads carrying electric current.

The cable connections must be made in accordance with regulations and the terminal screws tightened securely.

Finally, the connecting cable is to be secured with the mains cable cleat and the covering closed by pressing firmly (lock into place). Before switching on for the first time, any protective foil or stickers must be removed from the glass ceramic surface.

## ⚠ caution

Once connected to the mains supply check that all cooking zones are ready for use by briefly switching each on in turn at the maximum setting.

Sticking on the seal

- Clean the worktop around the cutout area.
- Stick the single-sided adhesive sealing tape provided on the underside of the hob around the outside edge ensuring that it is not stretched. The two ends of the tape should join in the middle of one side. After trimming the tape (allow it to overlap by 2–3mm), press the two ends together.

## i tips & information

The cutout section in the worktop is illustrated in the drawing with the dimensions 560 x 490 / 880 x 490mm. The appliance can also be built into a shorter cut-out section with the dimensions 560 x 485 / 880 x 485 mm.

# assembly

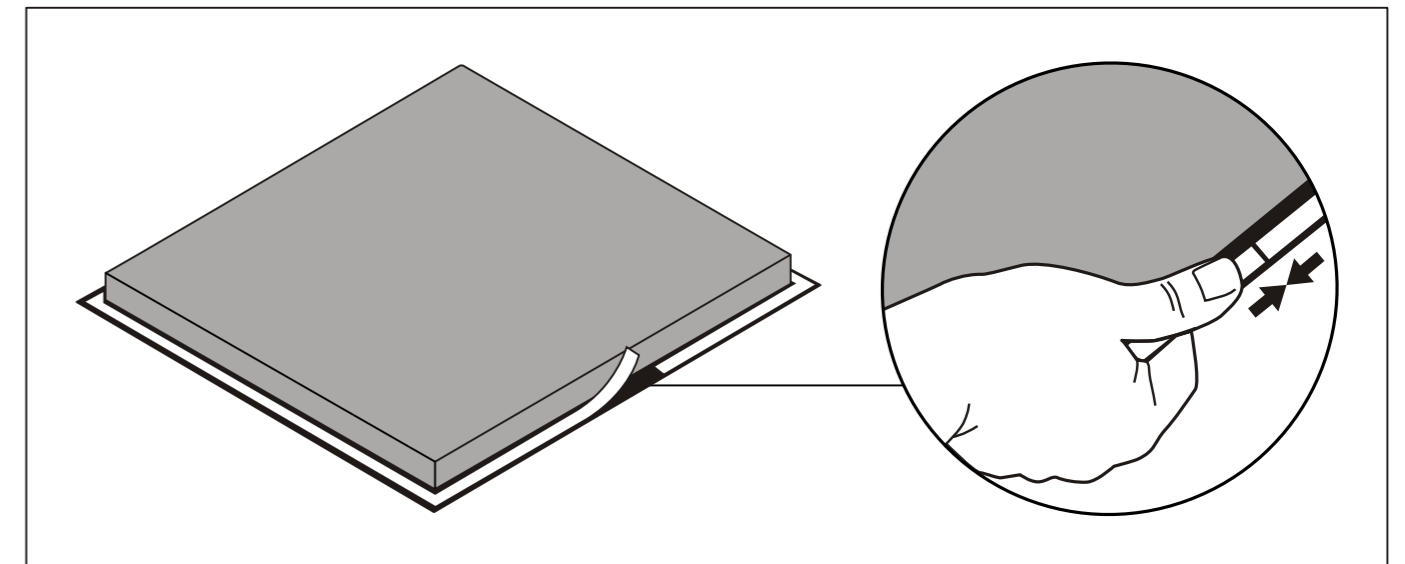
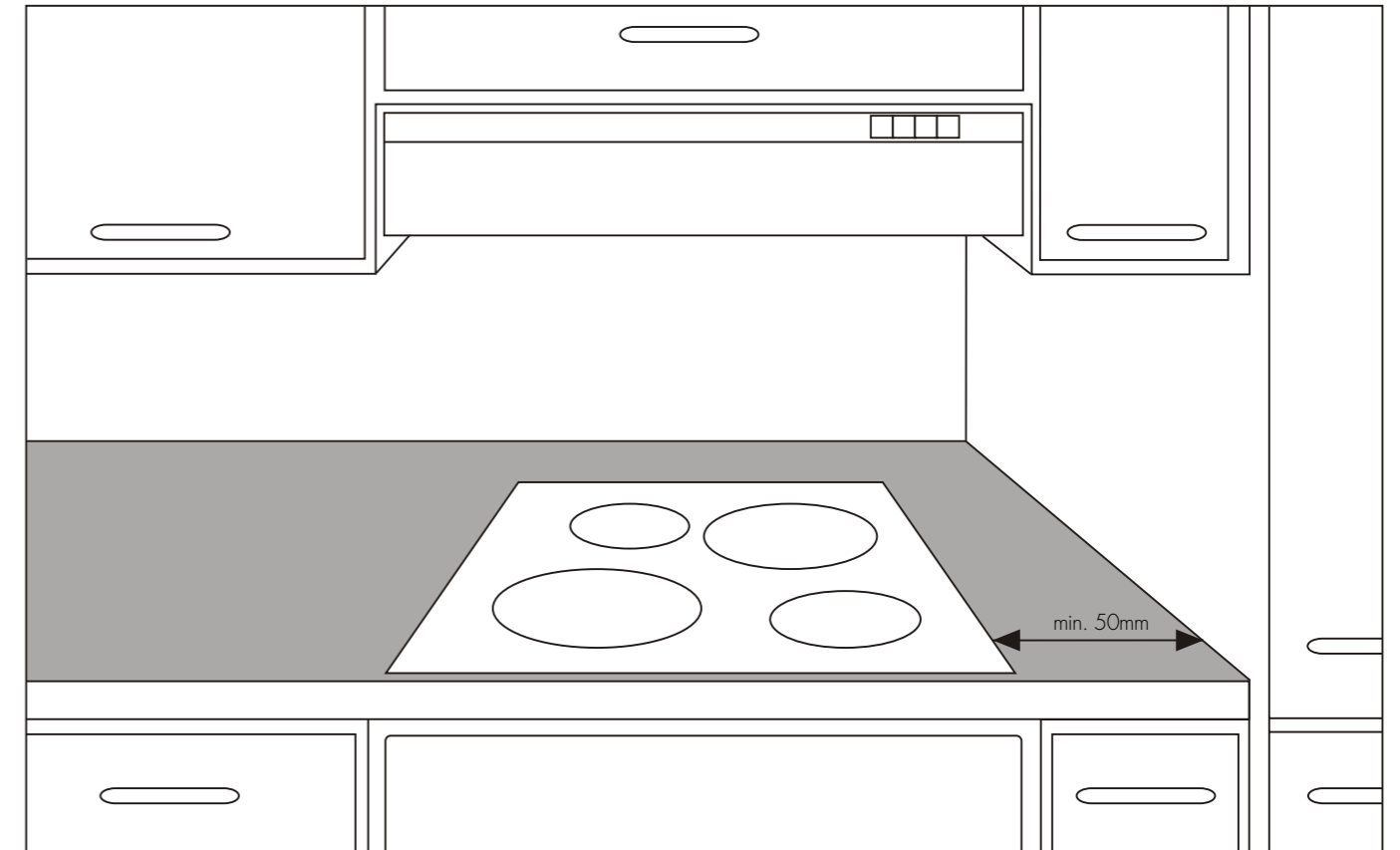

**CHC644BA / CHC744BA / SHC644BA**

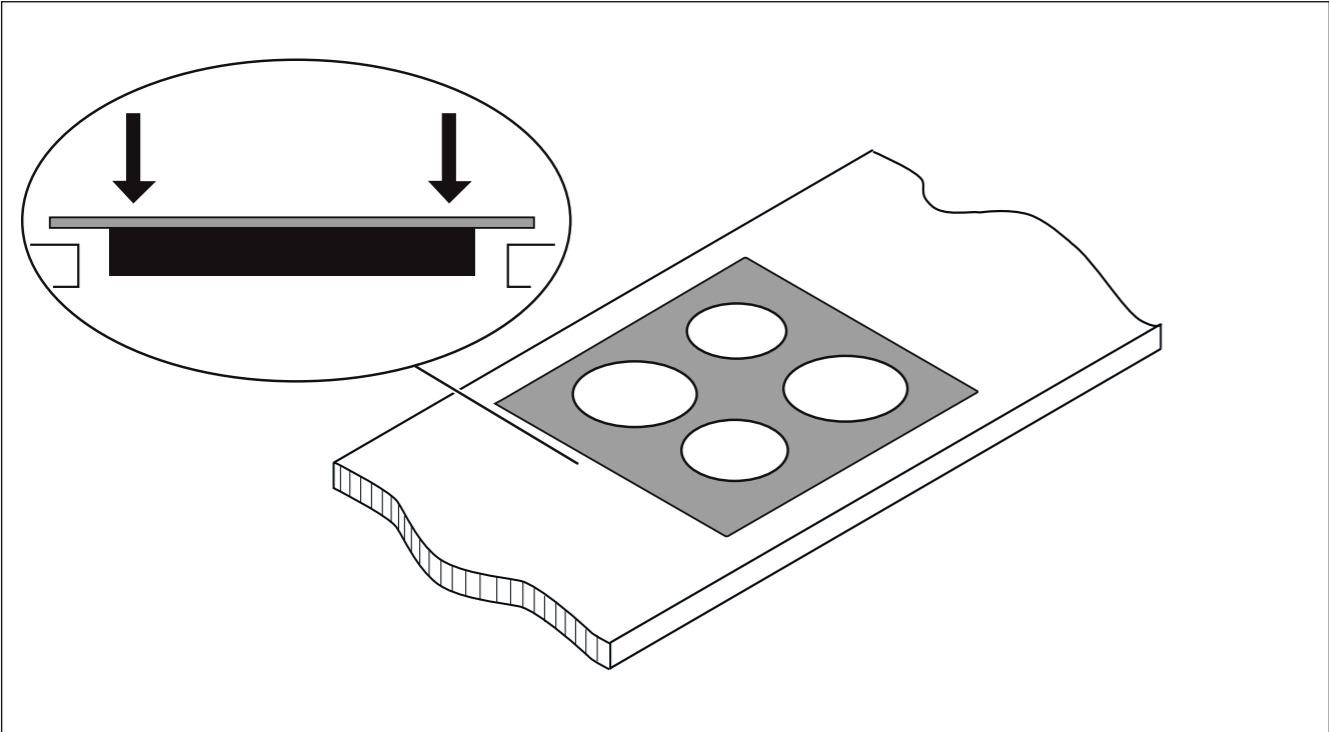
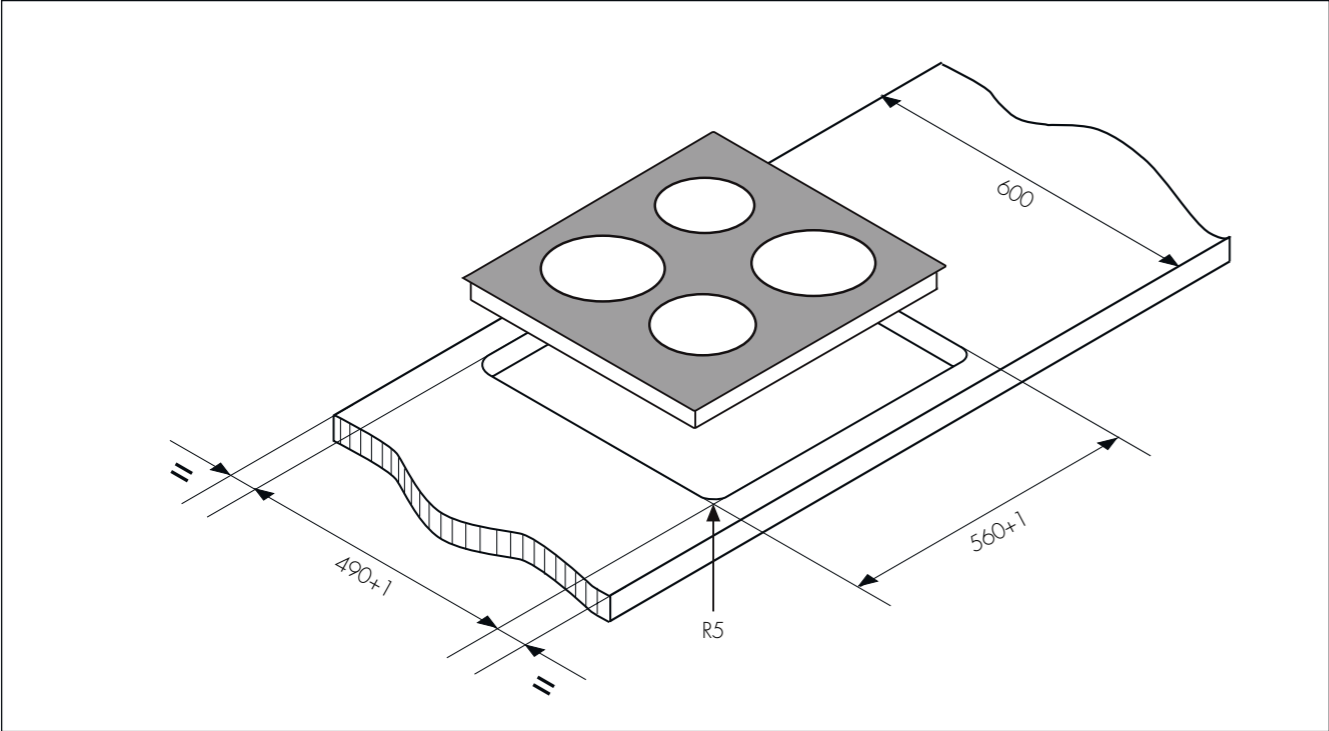

**CHC944BA / SHC944BA**

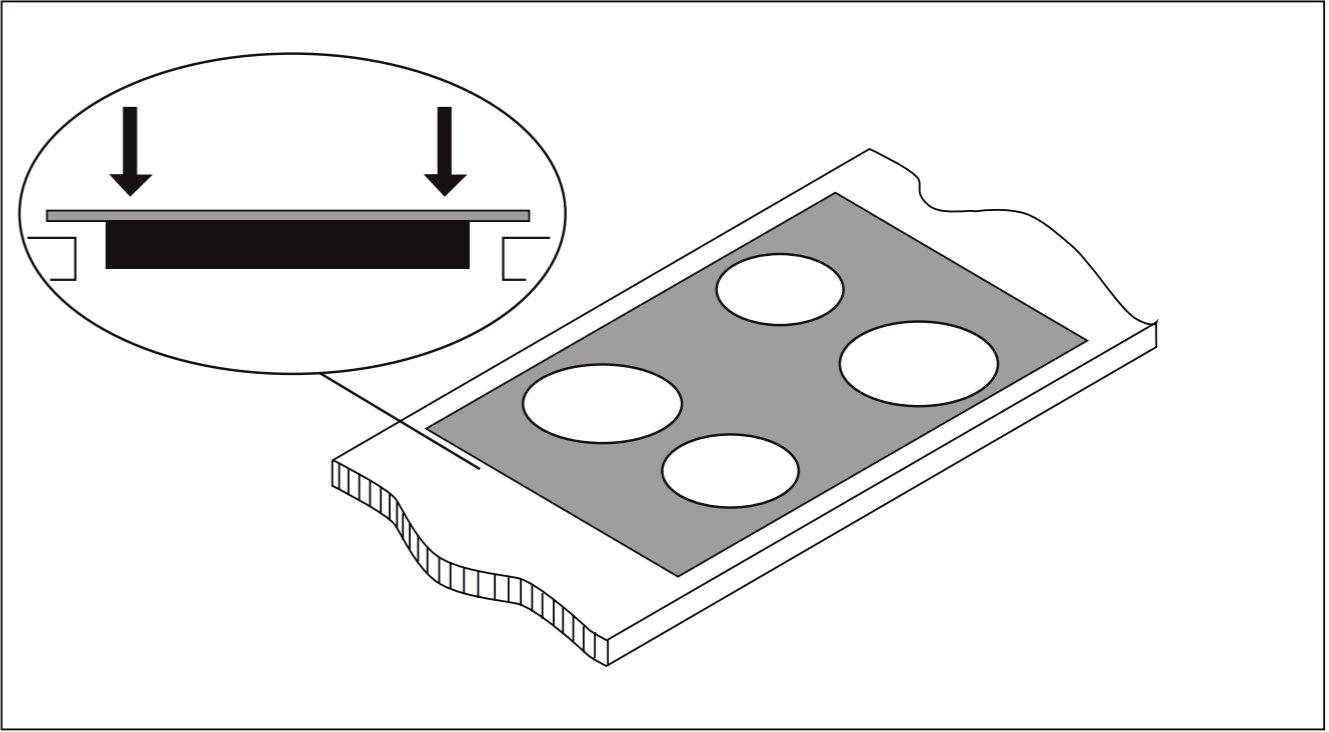
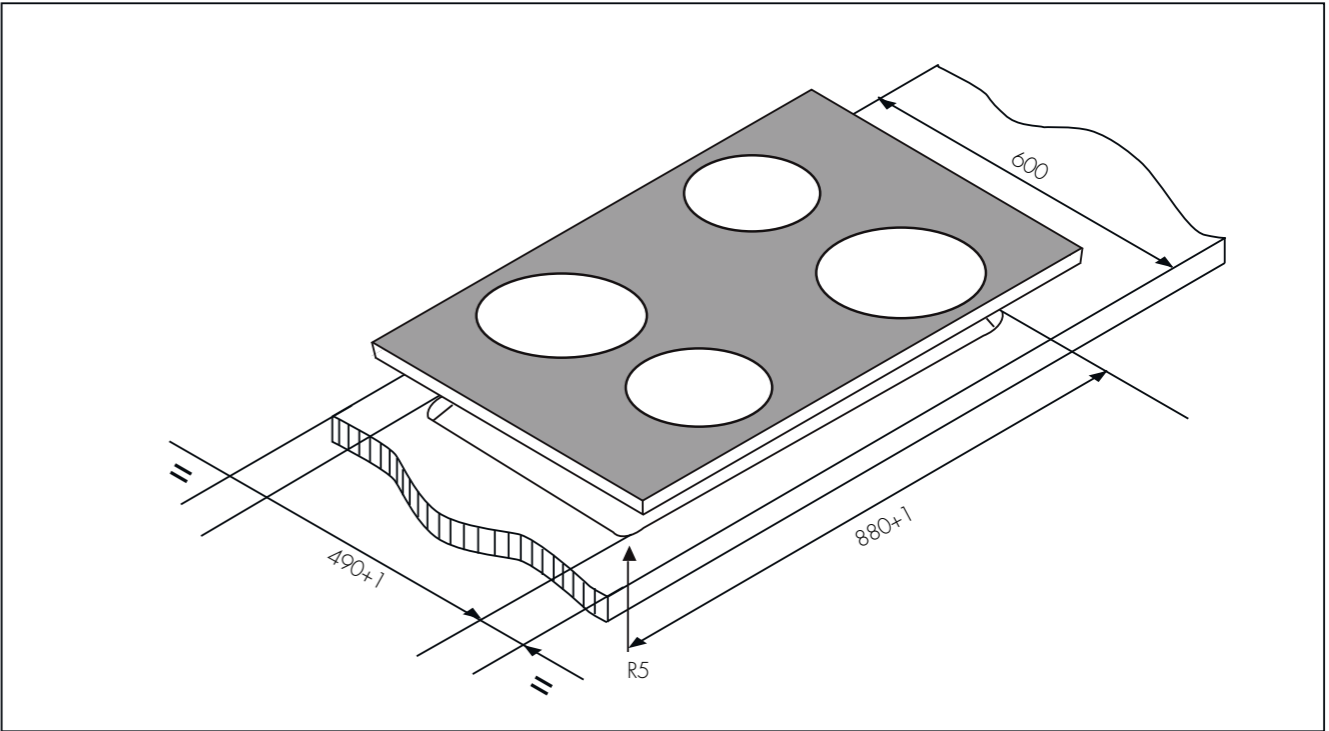

**Installation above cupboards or drawers**

Under hob access must be restricted by the addition of a board mounted at least 20mm from underside of hob.

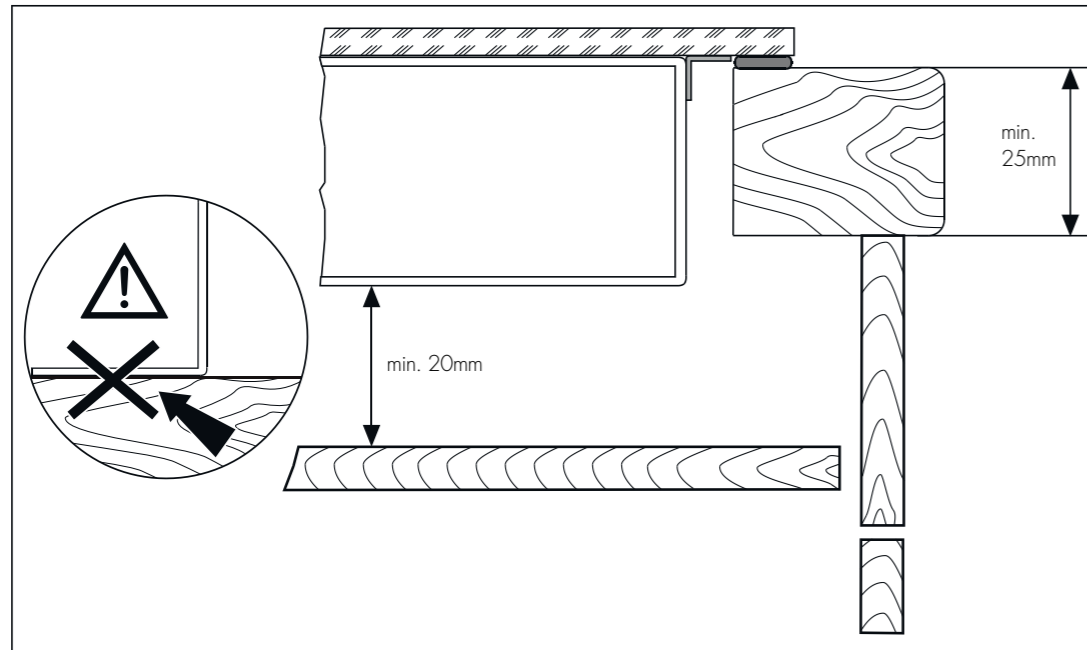

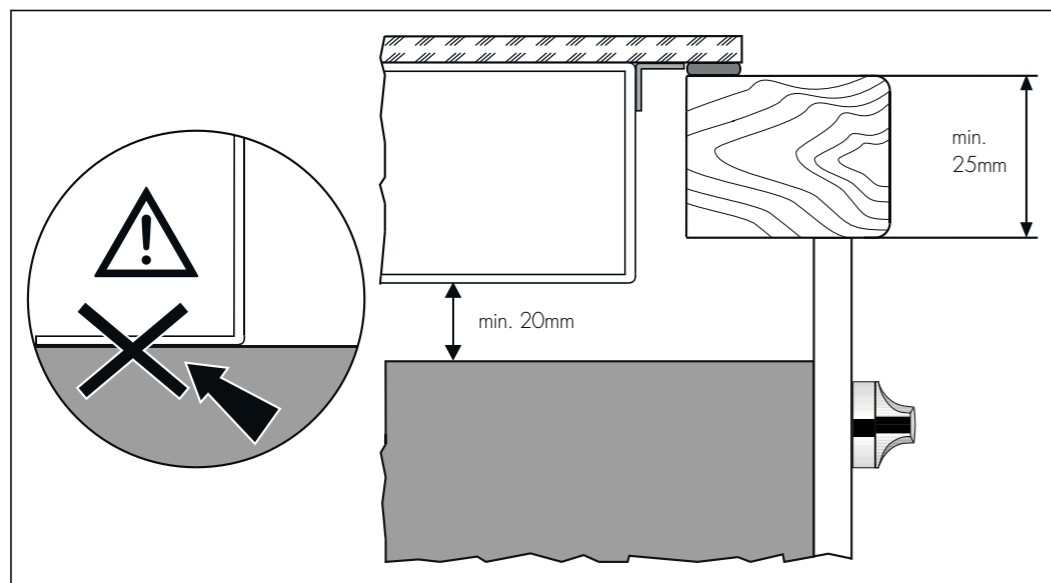

**Installation above cupboards or drawers**

Under hob access must be mounted at least 20mm from top of appliance.



**CHEF** PNC:949163312 ML:00  
 MODEL: CHC644BA  
 APP NO.: PEE2 100  
 Made in China  
 S NO.: 50Hz 6.0kW  
 220 - 240V  
 5022  
  
 (240)949163312(21)55108532

**CHEF** PNC:949163313 ML:00  
 MODEL: CHC744BA  
 APP NO.: PEE2 100  
 Made in China  
 S NO.: 50Hz 6.0kW  
 220 - 240V  
 5022  
  
 (240)949163313(21)55108537

**CHEF** PNC:949163314 ML:00  
 MODEL: CHC944BA  
 APP NO.: PEE2 101  
 Made in China  
 S NO.: 50Hz 6.5kW  
 220 - 240V  
 5022  
  
 (240)949163314(21)55108542

**SIMPSON** PNC:949163317 ML:00  
 MODEL: SHC644BA  
 APP NO.: PEE2 100  
 Made in China  
 S NO.: 50Hz 6.0kW  
 220 - 240V  
 5022  
  
 (240)949163317(21)55108557

**SIMPSON** PNC:949163316 ML:00  
 MODEL: SHC944BA  
 APP NO.: PEE2 101  
 Made in China  
 S NO.: 50Hz 6.5kW  
 220 - 240V  
 5022  
  
 (240)949163316(21)55108552







FOR SALES IN AUSTRALIA AND NEW ZEALAND  
 APPLIANCE: BUILT-IN OVEN, COOKTOP  
 AND FREESTANDING COOKERS

**This document sets out the terms and conditions of the product warranties for Electrolux Appliances. It is an important document. Please keep it with your proof of purchase documents in a safe place for future reference should you require service for your Appliance.**

1. In this warranty:
  - (a) 'acceptable quality' as referred to in clause 10 of this warranty has the same meaning referred to in the ACL;
  - (b) 'ACL' means Schedule 2 to the Competition and Consumer Act 2010;
  - (c) 'Appliance' means any Electrolux product purchased by you and accompanied by this document;
  - (d) 'ASC' means Electrolux authorised service centres;
  - (e) 'Electrolux' means Electrolux Home Products Pty Ltd of 163 O'Riordan Street, Mascot NSW 2020, ABN 51 004 762 341 in respect of Appliances purchased in Australia and Electrolux (NZ) Limited (collectively 'Electrolux') of 3-5 Niall Burgess Road, Mount Wellington, in respect of Appliances purchased in New Zealand;
  - (f) 'major failure' as referred to in clause 10 of this warranty has the same meaning referred to in the ACL and includes a situation when an Appliance cannot be repaired or it is uneconomic for Electrolux, at its discretion, to repair an Appliance during the Warranty Period;
  - (g) 'Warranty Period' means the Appliance is warranted against manufacturing defects in Australia for 24 months and in New Zealand for 24 months, following the date of original purchase of the Appliance;
  - (h) 'you' means the purchaser of the Appliance not having purchased the Appliance for re-sale, and 'your' has a corresponding meaning.
2. This warranty only applies to Appliances purchased and used in Australia or New Zealand and used in normal domestic applications and is in addition to (and does not exclude, restrict, or modify in any way) any non-excludable statutory warranties in Australia or New Zealand.
3. During the Warranty Period Electrolux or its ASC will, at no extra charge if your Appliance is readily accessible for service, without special equipment and subject to these terms and conditions, repair or replace any parts which it considers to be defective. Electrolux or its ASC may use remanufactured parts to repair your Appliance. You agree that any replaced Appliances or parts become the property of Electrolux. This warranty does not apply to light globes, batteries, filters or similar perishable parts.
4. Parts and Appliances not supplied by Electrolux are not covered by this warranty.
5. To the extent permitted by law, you will bear the cost of transportation, travel and delivery of the Appliance to and from Electrolux or its ASC. If you reside outside of the service area, you will bear the cost of:
  - (a) travel of an authorised representative;
  - (b) transportation and delivery of the Appliance to and from Electrolux or its ASC.

In all instances, unless the Appliance is transported by Electrolux or an Electrolux authorised representative, the Appliance is transported at the owner's cost and risk while in transit to and from Electrolux or its ASC.
6. Proof of purchase is required before you can make a claim under this warranty.

7. You may not make a claim under this warranty unless the defect claimed is due to faulty or defective parts or workmanship. Electrolux is not liable in the following situations (which are not exhaustive):
  - (a) the Appliance is damaged by:
    - (i) accident
    - (ii) misuse or abuse, including failure to properly maintain or service
    - (iii) normal wear and tear
    - (iv) power surges, electrical storm damage or incorrect power supply
    - (v) incomplete or improper installation
    - (vi) incorrect, improper or inappropriate operation
    - (vii) insect or vermin infestation
    - (viii) failure to comply with any additional instructions supplied with the Appliance;
  - (b) the Appliance is modified without authority from Electrolux in writing;
  - (c) the Appliance's serial number or warranty seal has been removed or defaced;
  - (d) the Appliance was serviced or repaired by anyone other than Electrolux, an authorised repairer or ASC.
8. This warranty, the contract to which it relates and the relationship between you and Electrolux are governed by the law applicable where the Appliance was purchased. Where the Appliance was purchased in New Zealand for commercial purposes the Consumer Guarantee Act does not apply.
9. To the extent permitted by law and subject to your non-excludable statutory rights and warranties, Electrolux excludes all warranties and liabilities (other than as contained in this document) including liability for any loss or damage whether direct or indirect arising from your purchase, use or non use of the Appliance.
10. For Appliances and services provided by Electrolux in Australia, the Appliances come with a guarantee by Electrolux that cannot be excluded under the ACL. You are entitled to a replacement or refund for a major failure and for compensation for any other reasonably foreseeable loss or damage. You are also entitled to have the Appliance repaired or replaced if the Appliance fails to be of acceptable quality and the failure does not amount to a major failure. The benefits to you given by this warranty are in addition to your other rights and remedies under a law in relation to the Appliances or services to which the warranty relates.
11. At all times during the Warranty Period, Electrolux shall, at its discretion, determine whether repair, replacement or refund will apply if an Appliance has a valid warranty claim applicable to it.
12. For Appliances and services provided by Electrolux in New Zealand, the Appliances come with a guarantee by Electrolux pursuant to the provisions of the Consumer Guarantees Act, the Sale of Goods Act and the Fair Trading Act.
13. To enquire about claiming under this warranty, please follow these steps:
  - (a) carefully check the operating instructions, user manual and the terms of this warranty;
  - (b) have the model and serial number of the Appliance available;
  - (c) have the proof of purchase (e.g. an invoice) available;
  - (d) telephone the numbers shown below.
14. You accept that if you make a warranty claim, Electrolux and its ASC may exchange information in relation to you to enable Electrolux to meet its obligations under this warranty.

**Important Notice**

Before calling for service, please ensure that the steps listed in clause 13 above have been followed.

<p><b>FOR SERVICE</b>                  or to find the address of your nearest state service centre in Australia  <b>PLEASE CALL 13 13 49</b>  <small>For the cost of a local call (Australia only)</small></p>	<p><b>SERVICE AUSTRALIA</b>                  ELECTROLUX HOME PRODUCTS                  electrolux.com.au</p>	<p><b>FOR SPARE PARTS</b>                  or to find the address of your nearest state spare parts centre in Australia  <b>PLEASE CALL 13 13 50</b>  <small>For the cost of a local call (Australia only)</small></p>
<p><b>FOR SERVICE</b>                  or to find the address of your nearest authorised service centre in New Zealand  <b>FREE CALL 0800 10 66 10</b>  <small>(New Zealand only)</small></p>	<p><b>SERVICE NEW ZEALAND</b>                  ELECTROLUX (NZ) Limited                  electrolux.co.nz</p>	<p><b>FOR SPARE PARTS</b>                  or to find the address of your nearest state spare parts centre in New Zealand  <b>FREE CALL 0800 10 66 20</b>  <small>(New Zealand only)</small></p>

# like to know more?

For further information on all appliances, or to obtain detailed dimension and installation information, call into your Retailer, phone or email our Customer Care team or visit our website:

## **Australia**

phone: ..... 1300 363 640  
fax: ..... 1800 350 067  
email: ..... [customercare@electrolux.com.au](mailto:customercare@electrolux.com.au)  
website ..... [chef.com.au](http://chef.com.au) (Chef models)  
..... [westinghouse.com.au](http://westinghouse.com.au) (Westinghouse models)

## **New Zealand**

phone: ..... 0800 234 234  
fax: ..... 0800 363 600  
email: ..... [customercare@electrolux.co.nz](mailto:customercare@electrolux.co.nz)  
website ..... [simpson.co.nz](http://simpson.co.nz) (Simpson models)  
..... [westinghouse.co.nz](http://westinghouse.co.nz) (Westinghouse models)

## **Top service**

Top Service encompasses the after sales service provided by The Electrolux Group to consumers including delivery, home service and spare parts.

**Chef. We are part of the Electrolux Family.**  
**To add a touch of professional inspiration to your home,**  
**visit [electrolux.com.au](http://electrolux.com.au)**