

A 460L frost free top mount refrigerator with best in class energy efficiency, FreshZone™ double insulated crispers & a mark resistant stainless steel finish.

RRP AUS \$1,869.00 AUS \$1,869.00



Product Details

FEATURES

Energy efficiency

Enjoy a big performance without a big bill. Our refrigerators are designed to be energy efficient protecting the environment and reducing your power costs.

FreshZone™ Double Insulated Crispers

Designed to maximise food preservation for fresher, better tasting food, the double insulated crispers increase temperature stability and humidity levels in the crisper.

FreshPlus Cooling

Keep your ingredients at their fresh flavourful best. When the fridge door is open, the innovative FreshPlus technology immediately begins the recooling process to replace the lost cold air faster when the door closes. This ensures better preservation of farm fresh food and helps minimise waste.

MultiZone Deli compartment

Designed to isolate odours and seal in freshness, discover the perfect place to store your artisan cheeses, cured meats and deli items safely away from other ingredients.

Multi-function electronic touch controls

Ideally located on the inside of the cabinet, you can set the temperature and use functions such as boost mode, fast ice, holiday mode and drinks chill with just a touch of a button.

LED Lighting

With our new LED lighting at both the top and sides of the fridge, the light-filled interior illuminates the content of your fridge so you can find anything you need quickly and easily.

Mark resistant, high quality stainless steel

The invisible, mark-resistant coating is easy to clean and helps protect the fridge exterior from fingerprints and grime.

FlexStor

Its never been easier to get organised with our door compartment storage system. By simply lifting and sliding, you can adjust the height and position of the door compartments to fit both small and large items. With FlexStor you can change the configuration whenever you need to customise your refrigerator.

FreshSense deodoriser

The in-built Fresh Sense deodoriser freshens the air and absorbs strong odours like seafood and cheese, to keep your fridge smelling clean and fresh.

Multi-flow air delivery

The intelligent airflow system evenly disperses air to ensure optimum temperatures so your food is kept fresher for longer.

Twist ice and serve

With a compact design and two removable ice trays, entertaining is a breeze when you always have ice ready for drinks.

Fridge & freezer door alarm

An alarm sounds if the door is left open to help keep the interior cool and reduce the risk of spoilage.

Frost free

Save your precious time with a freezer that doesn't ice up and need manual defrosting.

R600a refrigerant

Our fridges use R600a, a non-synthetic refrigerant that's more environmentally friendly than the commonly used R134a.

Boost mode

After a large grocery shop, use the Boost function when adding food to your fridge, so that the temperature decreases for 90 minutes before returning to the pre-set mode.

Drinks chill

Use the handy drinks chill feature to remind yourself when to take your drinks out of the freezer.

Over temperature freezer alarm

Protect the contents of your freezer with an alarm that sounds when the freezer temperature gets 10c over the set temperature for a period of 50 minutes (except during a defrost).

Holiday mode

Going away? Set the fridge to Holiday Mode to help minimise defrosting and save energy.

Crispers on telescopic runners

Enjoy effortless access to all of your food, even items right at the back of the crisper, with easy-slide runners that fully extend.

Fast Ice function

When adding a large amount of food to the freezer, simply use the Fast Ice function, which decreases the temperature to -23C for 90 minutes before returning to the pre-set mode.

Wine Caddy

Stylish, functional and space efficient, the steel bottle caddy can easily and safely store up to six large bottles.

Non-slip grips

The easy-clean dishwasher-safe door compartment grips look great and also help protect bottles and jars from moving around.

Capacity

With even more useable interior space, you can store and organise your food with ease.

BENEFITS**The leader in energy efficiency**

Designed with your needs and the environment in mind, the Electrolux FreshPlus refrigeration range sets new standards for energy efficiency. So not only will you enjoy lower running costs and a smaller environmental footprint, you'll also benefit from an ingenious design and an outstanding performance without compromise.

Maximise food freshness

The fresher the food is, the more delicious the taste. By increasing the stability of temperature and humidity levels in the double insulated crisper, food preservation is maximised. And that means better tasting farm fresh ingredients for all of your favourite dishes.

The FreshPlus™ advantage

Did you know that your fridge door is one of the most opened doors in your home? That's why we created our innovative FreshPlus™ technology. Designed to maintain the perfect temperature and detect when the fridge door opens, it immediately begins re-cooling to replace cold air for fresher, longer lasting, great tasting food.

Superior styling

With sleek styling, generous interior space, high-quality mark-resistant stainless steel, and LED lighting, Electrolux FreshPlus™ refrigerators bring the utmost style to your kitchen.

Specifications

PRODUCT PROFILE

Domestic warranty details (yrs)	2
---------------------------------	---

Additional domestic warranty for the sealed refrigeration system only (yrs)	3
---	---

Refrigerator Type	top mount
-------------------	-----------

Exterior door finish	Stainless steel
----------------------	-----------------

Handle design	bar handle
---------------	------------

Fridge door opening	left and right
---------------------	----------------

Cooling system	frost free
----------------	------------

Refrigerant	R600a
-------------	-------

DIMENSIONS

Total height (mm)	1725
-------------------	------

Cabinet height (mm)	1705
---------------------	------

Total width (mm)	699
------------------	-----

Cabinet width (mm)	693
--------------------	-----

Total depth (mm)	773
------------------	-----

Cabinet depth (mm)	641
--------------------	-----

Depth door open 90degree (mm)	1360
-------------------------------	------

Food compartment capacity (gross in litres)	341
---	-----

Freezer compartment capacity (gross in litres)	119
--	-----

Total Gross Capacity (L)	460
--------------------------	-----

Food compartment capacity (net in litres)	327
---	-----

Total Net Capacity (L)	426
------------------------	-----

ENERGY

Energy Star Rating	5
--------------------	---

Energy consumption (KWhr/yr)	260
---------------------------------	-----

REFRIGERATOR SYSTEM

Controls	electronic (with display)
----------	---------------------------

Controls location	internal
-------------------	----------

Controls type	touch
---------------	-------

Control functions	drink chill alarm, holiday mode, eco mode, fast ice function, boost mode
-------------------	--

Door alarm	fridge and freezer
------------	--------------------

FOOD COMPARTMENT

DELI-COMPARTMENT

Deli-Compartment Runner system	telescopic
--------------------------------	------------

Full width compartment	1
------------------------	---

SHELVING

Shelf material	glass
----------------	-------

CRISPERS

Crisper lid/shelf	glass
-------------------	-------

Crispers Runner system	telescopic
------------------------	------------

Full width crisper	1
--------------------	---

Crisper features	humidity controlled
------------------	---------------------

LIGHTING

Main light	LED
------------	-----

OTHER PROPERTIES

Other Properties-FOOD COMPARTMENT	Deodoriser, Steel wine caddy
-----------------------------------	------------------------------

DAIRY COMPARTMENT

Half width, with lid	2
----------------------	---

SHELVING

Shelving	glass shelf
----------	-------------

Number of shelves	1
-------------------	---

FREEZER DOOR

INTERNAL

Freezer door bins - full width	1
--------------------------------	---

FOOD COMPARTMENT DOOR

BINS

Shallow bin	1
-------------	---

Non-slip grip mats	Yes
--------------------	-----

FREEZER COMPARTMENT

ICE FACILITY

Twist ice and serve	2
---------------------	---

LIGHTING

Main light	LED
------------	-----

Dimensions

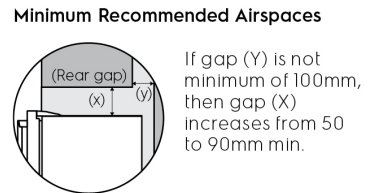
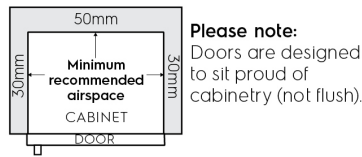
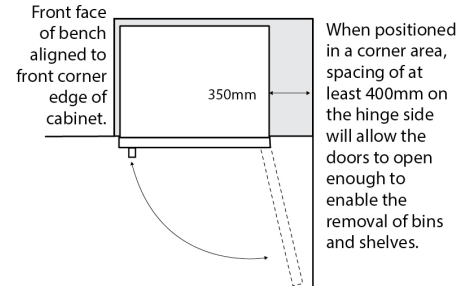
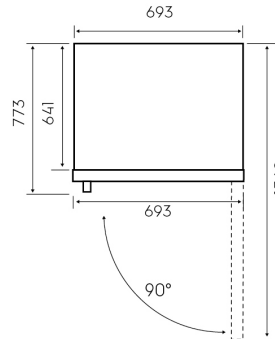
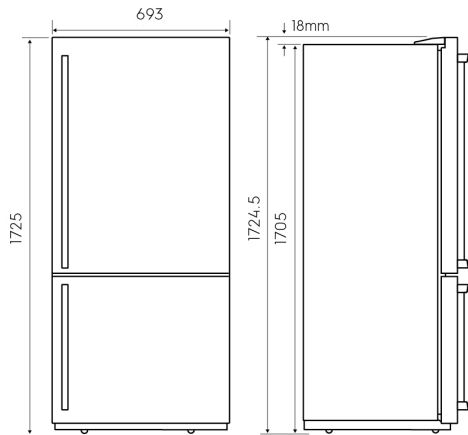

Joined dimensions

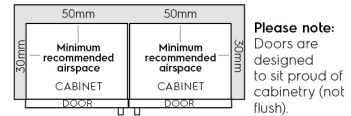
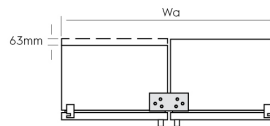
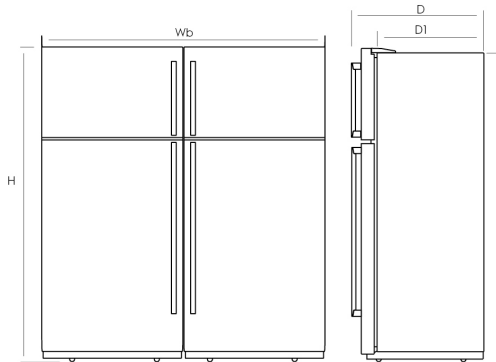

Joined cabinet dimensions

individual cabinet widths (W1)		cabinet height (H1)	max door height (H)	joined cabinet width (Wa)	joined door width (Wb)	max total depth (D)	max cabinet depth (D1)
model 1	model 2						
693	693	1705	1725	1407	1419	773	641
693	790	1705	1725	1504	1516	773	641
790	790	1705	1725	1601	1613	773	641

Terms and Conditions

IMPORTANT

This is a guide of product dimensions only. For complete installation instructions, refer to the manual provided with product.

PRODUCT INFORMATION

The descriptors and illustrations in this publication apply to the specific products and models described as at the date of issue. Under our policy of continuous product development, product specifications may change without notice. Prospective purchasers should therefore check with their retailer to ensure this publication correctly describes the products that are being offered for sale. All information supplied is to be used for general reference purposes only and is on the understanding that Electrolux Home Products Pty Ltd (Australia) and Electrolux (NZ) Ltd (New Zealand) will not be liable for any loss, liability or damage of whatever kind arising as a result of reliance on such information. Colours of products illustrated are as close as printing limitations allow. Electrolux will at all times comply with its obligations pursuant to law including Trade Practices (Australian Consumer Law) Act and Regulations.

WARRANTY

This warranty only applies to Appliances purchased and used in Australia or New Zealand and used in normal domestic applications and is in addition to (and does not exclude, restrict, or modify in any way) any non-excludable statutory warranties in Australia or New Zealand. All warranties are subject to the conditions set out in the warranty card accompanying the product when purchased.

ELECTROLUX HOME PRODUCTS AUSTRALIA

telephone: 1300 363 640

fax: 1800 350 067

email: customercare@electrolux.com.au

web: www.electrolux.com.au

ELECTROLUX HOME PRODUCTS NEW ZEALAND

telephone: 09 573 2230

fax: 09 573 2221

email: customercare@electrolux.co.nz

web: www.electrolux.co.nz