



TS9030
RAY·DANZ 3.1 Atmos Sound Bar with
Wireless Subwoofer



User manual

Contents

1	Before you begin	3
	Important safety instructions	4
	Disposal of your old product and battery	10

2	Welcome	11
	What's in the box	11
	Overview of the Sound Bar main unit	13
	Overview of the wireless subwoofer	15
	Remove the Sound Bar back cover	16
	Set up your Sound Bar system	16

3	Connect, install and pair	21
	Connect to your TV	21
	Optional: Connect your Blu-ray player	23
	Connect your Sound Bar to power supply	24
	Install/replace the remote control batteries	25
	Pair your wireless subwoofer to the Sound Bar	26

4	Optional connections	28
	Connect with the supplied optical cable	28
	Connect with the audio cable	30
	Pair the Sound Bar with your Bluetooth device	31

5 Use your Sound Bar system	33
Operate your Sound Bar with the top panel	33
Sound Bar LED display	33
Sound Bar Menu Operation	33
Set up Wi-Fi connection for music streaming	34
Listen to music from your Bluetooth device	36
Use the USB device for music playback	37

6 Specifications	38
-------------------------	----

7 Notice	40
Declaration of conformity	40
Disposal of your old product and battery	40

8 Trademarks	42
---------------------	----

9 FAQ	44
--------------	----

1 Before you begin

- Carefully read and observe all safety instructions in the safety leaflet
- This soundbar is intended for indoor use only. In case it accidentally gets in contact with small amounts of water, unplug immediately and use a dry cloth to remove the water.
- Unplug the soundbar if it is not used for long periods of time or during lightning storms.
- Make sure the soundbar is installed on a solid surface or solidly wall-mounted below your TV for the best experience.
- Only use AAA 1.5V non-rechargeable batteries for the remote control.
- In case any of the cables are visibly damaged or pinched, unplug the soundbar and replace the cable.
- Be careful not to sharply bend the HDMI and optical cable as they may affect the performance.
- Protect your hearing by adjusting to a proper volume. Predefined and customizable sound settings are available for your listening comfort.

Important safety instructions

Make sure you read all the safety information before you use this product.

TCL Entertainment Solutions Limited bears no responsibility for accidents or damages caused by unauthorized changes, modifications or improper use of the product.

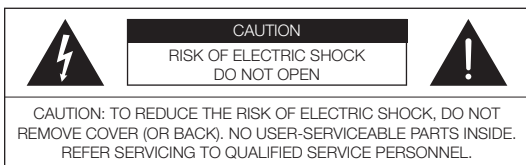

The lightning flash with arrowhead symbol, within an equilateral triangle is intended to alert the user to the presence of uninsulated dangerous voltage within the product's enclosure that may be of sufficient magnitude to constitute a risk of electric shock.



The exclamation point within an equilateral triangle is intended to alert the user to the presence of important operating and maintenance (servicing) instructions in the literature accompanying the product.



This symbol indicates that this product incorporates double insulation between hazardous main voltage and user accessible parts. When servicing, use only identical replacement parts.

Warnings

- To reduce the risk of fire or electric shock, do not expose this product to rain or moisture. This product should not be exposed to dripping or splashing. No objects filled with liquids, such as vases, should be placed on or near the product.
- The product is unstable if it is not properly placed or mounted to the wall. Be sure to follow the wall mounting instructions provided in the user manual to ensure your safety.
- Do not expose batteries to excessive heat such as sunshine, fire, and so forth.

Safety

- **Read these instructions** - Read all the safety and operating instructions before operating the product.
- **Retain these instructions** - Retain the safety and operating instructions for future reference.
- **Heed all warnings** - Adhere to all warnings on the product and in the operating instructions.
- **Follow all instructions** - Follow all operating and use instructions.
- **Do not use this apparatus near water** – The appliance should not be used near water or moisture – for example, in a wet basement or near a swimming pool and the like.
- **Clean only with a dry cloth.**

- **Do not block any ventilation openings.** Install in accordance with the manufacturer's instructions.
- **Do not install near any heat sources such as radiators, heat registers, stoves, or other apparatus (including amplifiers) that produce heat.**
- **Do not defeat the safety purpose** of the polarized or grounding-type plug. A polarized plug has two blades with one wider than the other. A grounding type plug has two blades and a third grounding prong. The wide blade or the third prong are provided for your safety. If the provided plug does not fit into your outlet, consult an electrician for replacement of the obsolete outlet.
- **Protect the power cord** from being walked on or pinched particularly at plugs, convenience receptacles, and the point where it exits from the product.
- **Use only attachments/accessories** specified by the manufacturer.
- **Use only with the cart,** stand, tripod, bracket, or table specified by the manufacturer, or sold with the apparatus. When a cart is used, use caution when moving the cart/apparatus combination to avoid injury from tip-over.
- **Unplug this apparatus** during lightning storms or when unused for long periods of time.



- **Refer all servicing** to qualified service personnel. Servicing is required when the apparatus has been damaged in any way, such as power-supply cord or plug damaged, liquid has been spilled or objects have fallen into the apparatus, the apparatus has been exposed to rain or moisture, does not operate normally, or has been dropped.
- **This appliance is** not intended for use by young children or infirm persons without supervision. Young children should be supervised to ensure that they do not play with the appliance.

Cautions

- To prevent electric shock, match wide blade of plug to wide slot, fully insert.
- Do not place any sources of danger on the product (for example: liquid filled objects, lighted candles).
- Disconnect the power cord to shut off when find trouble or not in use. The power cord shall be readily operable.
- Use of controls or adjustments or performance of procedures other than those described herein, may result in hazardous radiation exposure or other unsafe operation.
- The power cord/appliance coupler is used as the disconnect device, the disconnect device must remain readily operable.
- The rating label is located at the bottom or back of the product.

Battery precautions

- Do not mix batteries (old and new or carbon and alkaline).
- Do not dispose of batteries in fire or water.
- Recycle or dispose of batteries as per state and local guidelines.
- Danger of explosion if battery is incorrectly replaced. Replace only with the same or equivalent type.
- When the remote control is not to be used for a long time (more than a month), remove the battery from the remote control to prevent it from leaking.
- If the batteries leak, wipe away the leakage inside the battery compartment and replace the batteries with new ones.
- Keep away the batteries from heat or moisture.
- Do not carry or store batteries with other metallic objects. Doing so could cause batteries to short circuit, leak or explode.

For 5G WIFI Device

The device for operation in the band 5150–5250 MHz is only for indoor use to reduce the potential for harmful interference to co-channel mobile satellite systems.

Disposal of your old product and battery

Your product is designed and manufactured with high quality materials and components, which can be recycled and reused.

This product may contain lead and mercury. Disposal of these materials may be regulated due to environmental considerations. For disposal or recycling information, please contact your local authorities. This product contains non-removable batteries:

- Do not incinerate. Batteries may explode if overheated.
- For disposal or recycling information, please contact your local authorities.

CAUTION: Risk of explosion if the battery is replaced by an incorrect type.

CAUTION: replacement of a battery with an incorrect type that can defeat a safeguard.

CAUTION: disposal of a battery into fire or a hot oven, or mechanically crushing or cutting of a battery, that can result in an explosion;

CAUTION: leaving a battery in an extremely high temperature surrounding environment that can result in an explosion or the leakage of flammable liquid or gas.

CAUTION: a battery subjected to extremely low air pressure that may result in an explosion or the leakage of flammable liquid or gas.

2 Welcome

Congratulations on the purchase of your new TCL Sound Bar! After it is set up and connected, you can experience a superb sound quality and state-of-the-art design to best fit your home entertainment system. You are recommended to read through this user manual which helps you set up, connect and operate the product easily and properly.

Let's get started.

What's in the box



Sound Bar main unit with wireless subwoofer

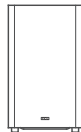

Wireless subwoofer



Remote control

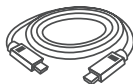

HDMI cable



Optical cable



Wall mounting screw x 2



AC power cord x 2



Wall mount template



AAA battery x 2



Quick start guide



Wall mount bracket x 2



User Manual







Wall screw x 2

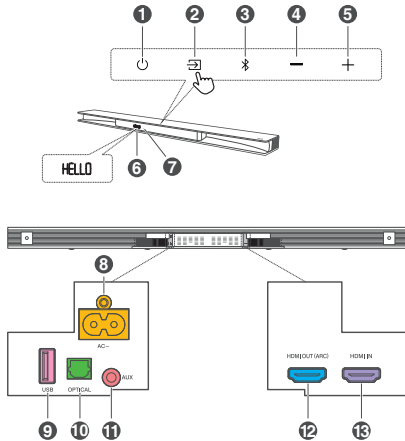

Wall anchor x 2

Overview of the Sound Bar main unit

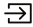

- 1  Press to turn the Sound Bar main unit on or off.
- 2  Press to switch the audio source among AUX/Bluetooth/Optical/HDMI in/HDMI ARC/USB modes.
- 3  Press to select the Bluetooth source. Press and hold to enter pairing mode.
- 4 - Press to decrease the volume level.

- 5 **+**
Press to increase the volume level.
- 6 **LED display**
It indicates the Sound Bar status (e.g. volume level, sound bar status).
- 7 **Green/red LED:**
It indicates Wi-Fi connection (e.g. Green: connected. Red: disconnected).
- 8 **AC input power connector**
- 9 **USB Type A connector (only for music playback)**
- 10 **Optical input connector**
- 11 **AUX input connector**
- 12 **HDMI OUT (ARC) connector**
- 13 **HDMI IN connector**

Overview of the wireless subwoofer

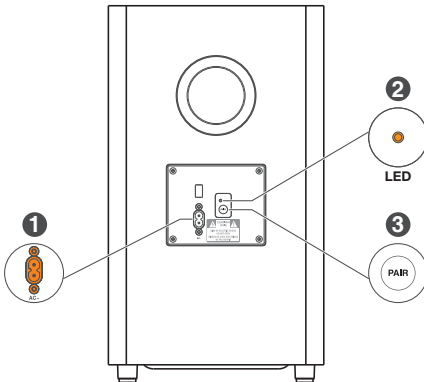

- 1 AC input power connector**
- 2 Amber LED indicator**
 - flashes slowly when the subwoofer is in standby mode.
 - flashes slowly when pairing is in progress.
 - remains on solidly when pairing is successful.
- 3 PAIR**

Press to activate pairing with the Sound Bar main unit.

Note

- The subwoofer is already paired at the factory. Manual pairing is needed only in case of troubleshooting.

Remove the Sound Bar back cover

Remove the back cover of your Sound Bar before connecting cables.

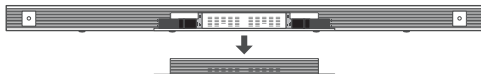

Set up your Sound Bar system

Notes

- Make sure you read all the safety information before you mount the Sound Bar main unit on the wall. (see 'Before you begin' on page 3).
- Make sure you use screws provided or specified by the authorized manufacturer.
- TCL Corporation bears no responsibility for accidents or damage caused by improper wall mounting and screws installation or insufficient wall strength, etc.
- Additional tools (not supplied) are required for installation.

Place your Sound Bar and subwoofer

You are recommended to place the Sound Bar main unit on the top of the table and right below the center of your TV. The distance between the subwoofer and the Sound Bar main unit should be less than 3 meters.

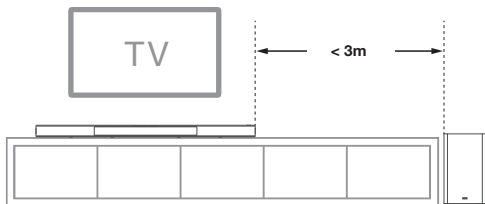

Wall mount your Sound Bar main unit

- 1 Place the supplied wall mount template on the wall. Make sure the wall mount template is at least 5cm below the center of the TV.
- 2 Use a level to make sure the Sound Bar is positioned accurately.
- 3 Use the tape to stick the wall mount template firmly on the wall.
- 4 Mark on the wall using each marking on the template through the mounting holes.
- 5 Take away the wall mount template.
- 6 Drill a screw hole at each marking on the wall.

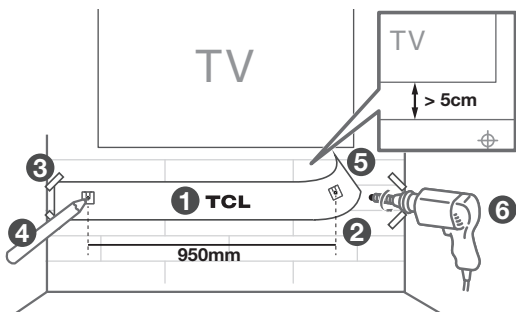

- 7 Insert the supplied wall anchors into 2 screw holes on the wall.
- 8 Insert the supplied wall bracket screws through the wall brackets into the wall anchors.
- 9 Fix and tighten the screws on the wall.



- 10 Insert the supplied wall mounting screws into the screw holes in the back of the Sound Bar main unit.

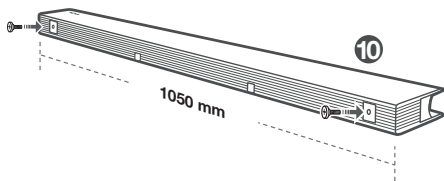

- 11 Hang the Sound Bar main unit on the wall mount brackets.

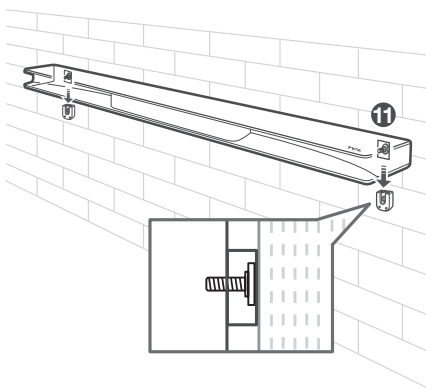

Notes

- Check the installation location before you mount the Sound Bar on the wall.
- You may consider to connect the cables first before mounting the Sound Bar on the wall.

3 Connect, install and pair

After you have fixed the position of the Sound Bar main unit, you can start connecting it to your TV, installing the remote control and pair it with the Sound Bar main unit.

Connect to your TV

Note

- Make sure your TV or device supports the HDMI ARC feature. For information, check the user manual of your TV or device.
- Please consult your TV's User Manual on how to verify if HDMI-CEC (also commercially known asT-Link,Anynet+, SimpLink, BRAVIA Link, EasyLink or VIERA Link) is enabled.

* All technology names mentioned are the trademarks or registered trademarks of their respective companies.

Connect one end of the supplied HDMI cable to the HDMI input connector on your Sound Bar main unit and another end to the HDMI ARC output connector of your TV or device.

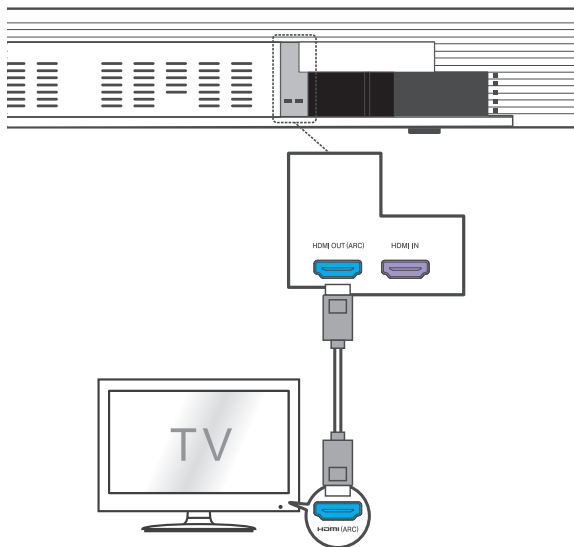

Optional: Connect your Blu-ray player

For ease of use, you are advised to connect a Blu-ray player to the TV and enjoy the Sound Bar through HDMI-ARC. However, in order to enjoy **Dolby TrueHD** based **Atmos** content that not all TVs may support through HDMI-ARC, you can optionally connect your Blu-ray player directly to the Sound Bar using the HDMI-in port.

Note

The Sound Bar will pass on the video signal to the TV. If it is not successful, turn on the Sound Bar and try again.

The HDMI input supports UHD (4K) and that it can also be used for game console to enjoy Dolby Atmos audio.

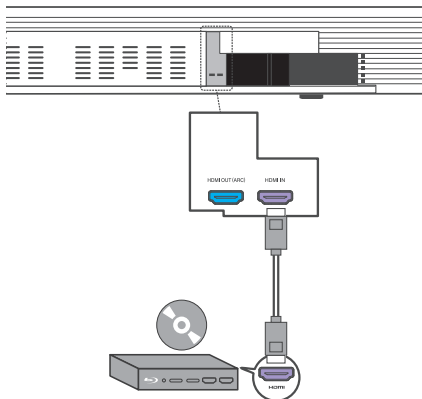

Connect your Sound Bar to power supply

- 1 Make sure that you have completed all other connections before connecting the Sound Bar to power supply.
- 2 Make sure the power supply voltage complies with your country's safety standards (see 'Specifications' on page 30).
- 3 Connect one end of a supplied AC power cord to the AC input connector on your Sound Bar main unit and another end to the power socket on the wall.

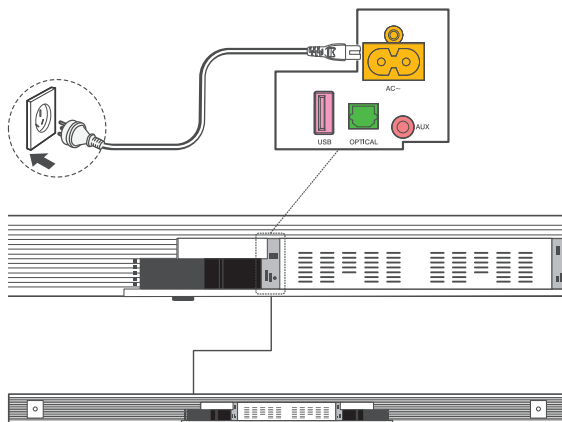

Install/replace the remote control batteries

Warnings

- Replace only with same or equivalent types of batteries. Performance may be affected when using NiMH rechargeable batteries.

- 1 Open the battery compartment, remove the old batteries if necessary.
- 2 Place two new AAA batteries into the battery compartment with the correct polarity (+/-).
- 3 Close the battery compartment.

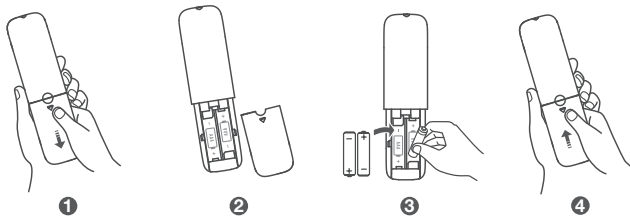

Setup is complete. Your Sound Bar is ready to use. For more information about how to access different connection options on your Sound Bar, see the following chapter.

Pair your wireless subwoofer to the Sound Bar

When the wireless subwoofer is connected, you can enjoy powerful deep bass sounds and a truly immersive audio experience.

Auto pairing

Make sure both the Sound Bar and wireless subwoofer are connected to the power supply and are turned on.

- The Sound Bar will pair with the subwoofer automatically.
- The amber LED will flash when pairing is in progress.
- The amber LED will remain on solidly when pairing is successful.

Note

- Do not press **PAIR** at the back of the wireless subwoofer during auto pairing.
- If auto pairing is not successful, you can pair the subwoofer with the Sound Bar manually.

Manual pairing

- 1 Make sure the Sound Bar and wireless subwoofer are properly connected to the power supply.
- 2 Press **PAIR** at the back of the wireless subwoofer until the amber LED on the subwoofer flashes slowly.
→ The wireless subwoofer is ready to pair.
- 3 Press \odot on the top panel of your Sound Bar main unit or remote control to power on your Sound Bar main unit.
→ The Sound Bar and wireless subwoofer will pair automatically.
→ Pairing is successful. The amber LED remains on solidly.

Note

- If the amber LED at the back of the subwoofer still flashes after pairing, it means pairing is not successful. Disconnect the AC power cord from the wireless subwoofer and then connect again after 3 minutes. Then repeat steps 1 to 3.

4 Optional connections

You can also connect the Sound Bar with your TV or other audio devices through the optical or audio cable.

Note

- The best way to connect your TCL Sound Bar to your TV is (in order of preference): 1) HDMI-ARC; 2) Digital optical (SPDIF); 3) AUX (audio cable); 4) Bluetooth.

Connect with the supplied optical cable

- 1 Make sure you have muted the audio of your TV. For information, check the user manual of your TV.
- 2 Make sure Sound Bar back cover is removed.
- 3 Remove the protective caps from the optical cable.
- 4 Connect one end of the optical cable to the optical input connector on your Sound Bar main unit and another end to the optical output connector of your TV or device.

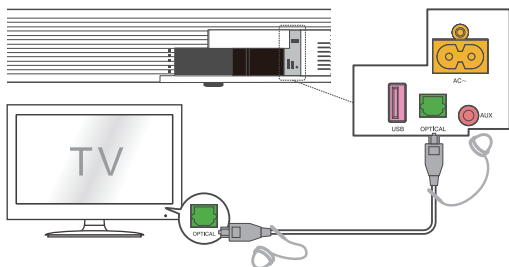

Note

- If there is no sound output from the Sound Bar main unit and the LED flashes rapidly, try to activate the PCM signal output on your TV. PCM is the most common digital audio format used and ensures compatibility.

Direction for setting up your Sound Bar using an optical cable



Do not bend or kink the optical cable (SPDIF) as it is fragile and can easily get damaged and broken.

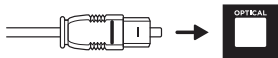

To get the best possible audio experience using the optical cable:

- 1 Press the settings button on your TCL TV remote.
- 2 Navigate to Audio options.
- 3 Set TV speakers to off.

Connect with the audio cable

- 1 Make sure Sound Bar back cover is removed.
- 2 Connect one end of the audio cable (not supplied) to the AUX input connector on your Sound Bar main unit and another end to the headphone or audio output connector on your TV or device. This will disable the sound of your TV built-in speakers.

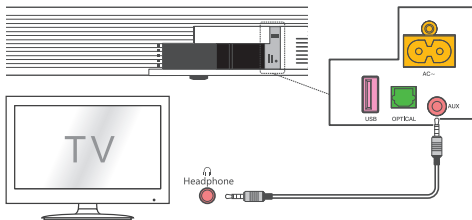



Pair the Sound Bar with your Bluetooth device

You can stream music from your mobile device through Bluetooth connection.

Notes

- Make sure your wireless device supports the Bluetooth function.
- The operational range between the Sound Bar main unit and your Bluetooth device is approximately 10 meters (without any obstacle between the Bluetooth device and Sound Bar main unit).

- 1 Press  on the top panel of your Sound Bar main unit or remote control.
- 2 Press  on the top panel of your Sound Bar or **BT** on the remote control to enter the Bluetooth mode.
- 3 There are two ways to do the pairing:
 - Press and hold  on the top panel of your Sound Bar main unit; or
 - Press and hold **▶I/OK** on the remote control.→ **PAIR** is flashing on the LED display. The Sound Bar is ready to pair.
- 4 Power on your Bluetooth device and activate its Bluetooth function.

5 Select **TCL RAY-DANZ** on the pairing list of your Bluetooth device.

→ You hear a sound signal.

→ Pairing is successful.

Tip

- When you turn on the Sound Bar next time, it will be reconnected to the last connected Bluetooth device automatically.

6 To disconnect the Bluetooth function, you can:

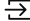
- press  on the Sound Bar main unit to switch to another source; or
- disable the Bluetooth function on your device; or
- press and hold **▶II/OK** on the remote control for 3 seconds. If you cannot find the model name **TCL RAY-DANZ** on your Bluetooth device, press and hold **▶II/OK** on the remote control. You will see **PAIR** flashing on the LED display. Now the Sound Bar main unit is entering the pairing mode.

5 Use your Sound Bar system

Operate your Sound Bar with the top panel

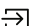
- 1 Make sure the Sound Bar is properly connected to power supply and sources.
- 2 Press  on the top panel of your Sound Bar main unit or remote control to power on the Sound Bar.
- 3 Press  on the Sound Bar or the source buttons on the remote control to switch to the correct source.

Sound Bar LED display

The LED display on the front of the Sound Bar gives you information about different Sound Bar status.

Sound Bar Menu Operation

In Standby mode, holding the "Play-Pause/OK" key for 5 seconds will bring you to the system settings menu. You can navigate with VOL +/- and select options with "Play-Pause/OK". This menu allows you to reset the system to factory settings and may offer additional settings.

Set up Wi-Fi connection for music streaming

1. Power on the sound bar.
2. On an Android phone, open the Google Home app and continue with step 3a, on an iOS device, go to Settings - Wi-Fi and continue with step 3b.
- 3a. In the Google Home app, make sure you are signed in and follow the on-screen instructions to complete the setup process.
- 3b. In Settings - WiFi, look for "TCL RAY-DANZ" under "SETUP AS NEW AIRPLAY SPEAKER" and complete the setup process.
4. Once setup is complete via either 3a or 3b, you can now enjoy both Chromecast built-in and AirPlay from any device on the same network.
5. After this setup you may see an message on the sound bar display that there is new software available (NEW SW OK/NOT"). Please press "Play-Pause/OK" button on your remote control to download software and upgrade your sound bar or any other key to skip for now.
6. Sound bar is an individual multi-channel audio system, Pair two speakers for stereo sound is not supported for current devices.
Speaker Pair: pair two speakers to create a wilder sound stage for your music, to start, place both speakers in the same room.

	Sound Bar status	LED display
Power	Power on	HELLO
	Power off	STANDBY
	Standby	•
Source	Bluetooth	BT
	Optical	OPT
	HDMI IN	HDMI1 IN
	HDMI ARC	HDMI2 ARC
	USB	USB
Bluetooth	Searching mode	BT FLASHING
	Pairing mode	PAIR
Volume control	Volume level	VOLUME
	Minimum volume reached	V MIN
	Maximum volume reached	V MAX
	Mute	MUTE
Bass/Treble	BASS +/-	BAS+3
	TREBLE +/-	TRE-3
Vertical surround mode	SURROUND ON	SUR ON
	SURROUND OFF	SUR OFF
Sound modes	Movie, Music, TV, BOOST	MOVIE MUSIC TV BOOST
Others	Unsupported format	NOT SUPPORT FORMAT
	USB unavailable	NO USB
	Audio format detected	PCM AUDIO / DOLBY AUDIO /
		DOLBY ATMOS

Listen to music from your Bluetooth device

- 1 Make sure that your device supports A2DP and/or AVRCP. For information, check the specification of your device.
- 2 Pair your Bluetooth device with the Sound Bar main unit (see 'Pair the Sound Bar with your Bluetooth device' on page 24).
- 3 Start listening to music stored in your Bluetooth device through the Sound Bar.
 - If your Bluetooth device supports A2DP, you can listen to music, but you cannot control the playback.
 - If your Bluetooth device supports AVRCP, you can listen to music and control music playback with the remote control. Press **▶/OK** on the remote control to pause or resume music playback. Press **◀◀/▶▶** to skip to the previous/next track.

Note

- The operational range between the Sound Bar main unit and your Bluetooth device is approximately 10 meters (without any obstacle between the Bluetooth device and Sound Bar main unit).

Use the USB device for music playback

- Press **▶/OK** on the remote control to listen to/pause/resume the music.
- Press **◀◀** or **▶▶** on the remote control to skip to the previous or next track.
- Press **+** or **-** to increase or decrease the volume level.

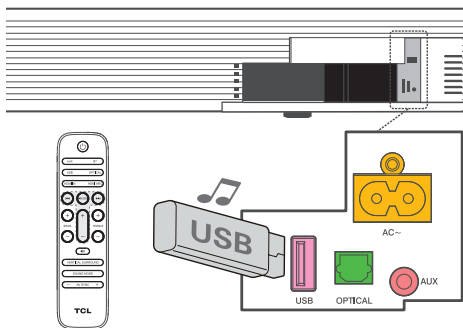

Tip

- This Sound Bar can support USB devices of up to 32GB memory and the supported file formats are MP3, WAV, FLAC.

6 Specifications

Sound Bar main unit

- Power supply: AC~100-240V, 50/60Hz
- Power consumption: 30 W
- Power consumption at standby mode: < 2W
- Impedance: 6 Ω
- Frequency response: 150 Hz~ 20 kHz
- Dimensions (W x D x H): 1050 x 110 x 55 mm
- Weight: 2.6 kg
- Operating temperature: 0°C - 45°C

Wireless subwoofer

- Power adapter: AC~100-240V, 50/60Hz
- Power consumption: 30 W
- Power consumption at standby mode: \leq 2W
- Frequency response: 40 Hz- 150 Hz
- Frequency range: 2404.5 Mhz – 2479.5 Mhz
- Max transmitting power: -3.11 dBm
- Dimensions (W x D x H): 240 x 240 x 420 mm
- Weight: 5.5 kg

Bluetooth

- Bluetooth version: 5.0, Bluetooth profile - Bluetooth stereo supported (Advanced Audio Distribution Profile - A2DP; Audio Video Remote Control Profile - AVRCP)
- Frequency range: 2402 Mhz – 2480 Mhz
- Max transmitting power: 9.7 dBm

Wi-Fi

- 2.4G Wi-Fi Maximum E.I.R.P: 17.0dBm
- 2.4G Wi-Fi Frequency bands: 2412 MHz ~ 2462 MHz

- 5G Wi-Fi (Band 1, Band 2, Band 3) Maximum E.I.R.P: 17.99dBm
- 5G Wi-Fi (Band 4) Maximum E.I.R.P: 10.0dBm
- 5G Wi-Fi Frequency bands: 5150 MHz ~ 5350 MHz,

Remote control

- Distance/Angle: 6m/30°
- Battery type: 1.5V AAA battery x 2, user replaceable.

7 Notice

Declaration of conformity

Hereby, TCL Corporation declares that this product is in compliance with the essential requirements and other relevant provisions of Directive 2014/53/EU.

Disposal of your old product and battery



Your product is designed and manufactured with high quality materials and components, which can be recycled and reused.



This symbol on a product means that the product is covered by European Directive 2012/19/EU.



This symbol means that the product contains a battery covered by European Directive 2013/56/EU which cannot be disposed of with normal household waste. Inform yourself about the local separate collection system for electrical and electronic products and batteries. Follow local rules and never dispose of the product and batteries with normal household waste. Correct disposal of old products and batteries helps prevent negative consequences for the environment and human health.

Remove the disposable battery

To remove the disposable batteries, see the section 'Install/replace the remote control batteries'.

Environmental protection and sustainability

We have omitted all unnecessary packaging and make sure it is eco-friendly and sustainable.

8 Trademarks

Bluetooth



The Bluetooth® word mark and logos are registered trademarks owned by Bluetooth SIG, Inc. and any use of such marks by TCL Corporation under license. Other trademarks and trade names are those of their respective owners.

Dolby Atmos



Dolby, Dolby Atmos, and the double-D symbol are registered trademarks of Dolby Laboratories Licensing Corporation. Manufactured under license from Dolby Laboratories. Confidential unpublished works. Copyright © 2012-2020 Dolby Laboratories. All rights reserved.

HDMI



HDMI, and HDMI logo and High-Definition Multimedia Interface are trademarks or registered trademarks of HDMI licensing LLC.

Apple Airplay



To control this AirPlay 2-enabled speaker, iOS 11.4 or later is required.

Apple, AirPlay, Apple TV, Apple Watch, iPad, iPad Air, iPad Pro, iPhone, and Lightning are trademarks of Apple Inc., registered in the U.S. and other countries..

ChromeCast Build-in



Google, works with Google Assistant and Chromecast built-in are trademark of Google LLC.

Works with Google assistant



Google, works with Google Assistant and Chromecast built-in are trademark of Google LLC.

9 FAQ

No power

- Make sure the AC power cord and AC input connector are connected properly.
- Make sure there is power supply.
- Make sure the Sound Bar has turned on.

No sound

- Make sure the audio cable is connected to the Sound Bar and your device.
- Make sure you have selected the correct source.
- Press **+** to increase the volume level.
- Make sure the Sound Bar is not muted.

The remote control does not work.

- Make sure the distance of the remote control and the Sound Bar main unit is within operational range.
- Make sure the batteries are correctly inserted.

I hear distorted sound.

- Make sure the cables are properly connected.
- Make sure you have selected the correct source.
- Make sure the TV is muted if you play audio from the TV.

I cannot find the Bluetooth name of this Sound Bar on my Bluetooth device.

- Make sure the Bluetooth function is activated on your Bluetooth device.
- Make sure the Sound Bar has paired with your Bluetooth device.
- Make sure the Sound Bar has unpaired with another device.

Does this Sound Bar work with any TV?

- The Sound Bar is compatible with any TV that has one of the these ports: 1. HDMI supporting ARC (preferred); 2. Optical audio output (TOSLink); 3. Headphone output.

When the Sound Bar and TV are both on, there's an echo effect.

- Simply mute the TV speaker to have the Sound Bar as the singular source of sound.

How many sound modes are available?

Four sound modes – Movies, Music, TV and Boost.

What are the subwoofer LED indicator status during pairing?

- Standby mode: flashes slowly.
- Pairing: flashes quickly.
- Paired: on solidly.

How do I get the best Wi-Fi connection?

- This soundbar supports both 2.4GHz and 5GHz Wi-Fi frequencies. It's generally best to use the same network name (SSID) on your router so the product will select the best network automatically. In case you have different network names for the two different frequencies, try out which one provides the best performance for you. Keep in mind that 2.4GHz has better range which in most cases is more important than the higher speed 5GHz offers
- If you see a lock icon, your Wi-Fi network requires a password, so make sure you have it available.
- Ensure your Internet is working properly. Restarting your router and modem will solve most Wi-Fi network issues.

For further support, visit:

www.tcl.com/au

www.tclelectronics.co.nz

**WE ARE
READY TO
HELP** **contact us first with
any questions**



TCL Electronics Australia Pty Ltd.

ABN 83 111 032 896

Telephone: 1300 738 149

service.au@tcl.com

www.tcl.com/au

TCL Electronics New Zealand Pty Ltd.

NZBN 9429043411917

Telephone: 0800 449 750

service.nz@tcl.com

www.tclelectronics.co.nz

Copyright © 2020 TCL. All rights reserved.
TS9030_AU_EN_UM_V1.0

