





HYDROTAP G5 BC CUBE CHROME



BOILING



CHILLED

FILTERED

Order Code H53784Z00AU

Zip HydroTap Design Range Boiling, Chilled, Filtered water system features a single under bench command centre including full colour interactive touch screen display with pin code protection and customisable settings including boiling water safety mode, 3 energy saving modes including ON/OFF timers and 2 hour sleep mode, 'Quiet' mode with automated intelligent fan speed adjustment, SteriTouch® antimicrobial protection impregnated into key water paths for enhanced hygiene, 100% water efficient air cooled technology, and 0.2 micron water filtration.

Manufacturing Code	H53784Z00AU
Capacity	Residential



Tap	Zip HydroTap Design Range CUBE Tap (Chrome)
Water Pressure	Min 170kPa - Max 700kPa
Water Connection	1/2" BSP (G1/2)
Water Supply Requirements	Cold
Water Valves	Integrated 500kPa Pressure limiting valve and Dual Check Valve
Power Rating	1.44kW 220-240V 50Hz
Power Supply	1 x 10 Amp socket outlet
Dimensions	W280mm x D455mm x H333mm
Product Approvals	WaterMark, RCM, ARC
Warranty	5 years (appliance warranty 36 months plus additional 24 months tank warranty)

Installation Requirements

'1. Installation and connection of your Zip HydroTap must be carried out by a qualified person, observing national and local regulations.2. You will require suitable mains electrical and drinking water connections, plus waste water drainage all within 1.5 metres of the product.3. HydroTap is air-cooled so discrete cabinetry cut-outs are required for ventilation.4. Installation on most bench tops is straightforward however some stone bench tops may require a specialised cutting service.5. If you live in a hard water area, we recommend installation of a Zip scale filtration kit.6. Installation by Zip Professional Service can be arranged with a phone call or through www.zipwater.com'

Installation Detail



Ventilation requirements

Contact your local service provider if ventilation is not suitable

HydroTap Tap options

Clearance envelope

Position the Tap and the Command Centre as close together as possible.

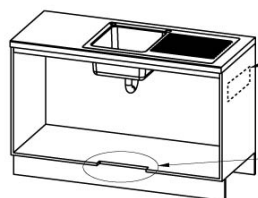
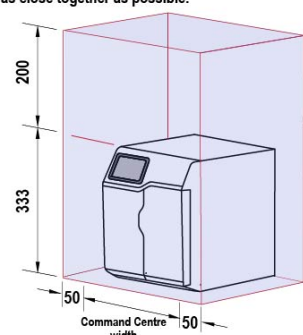

Air outlet louvre (if required)
Cut-out in door/wall, towards
the top of the cabinet

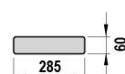

Air inlet cut-out (required)
Cut-out in cabinet floor

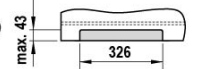

Tap Positioning

Tap Positioning
Position the Tap to dispense into the sink, allowing clearance for a cup or teapot. Alternatively, mount on a Font (available as an accessory).

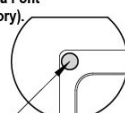

Ø35mm hole for
HydroTap Tap

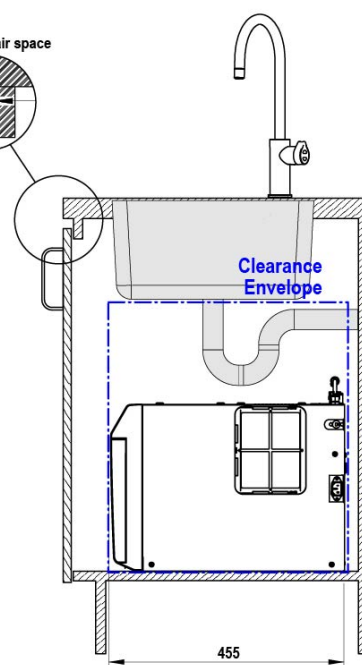
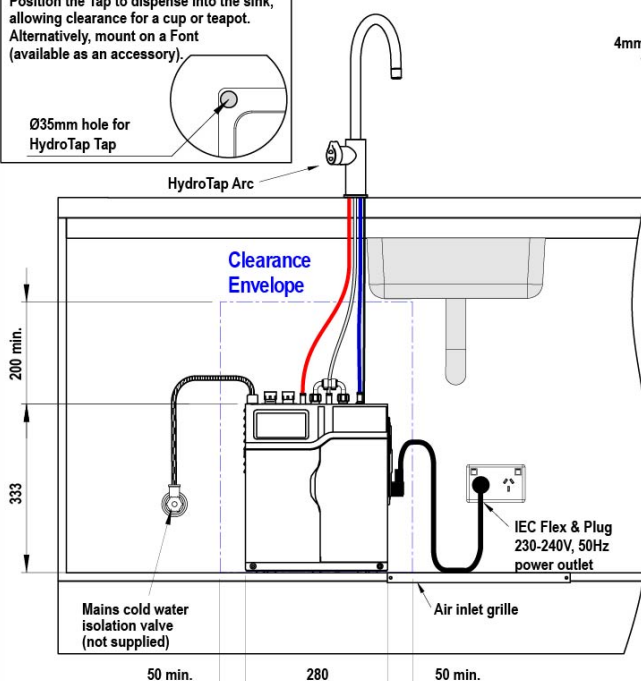

HydroTap Arc Tap

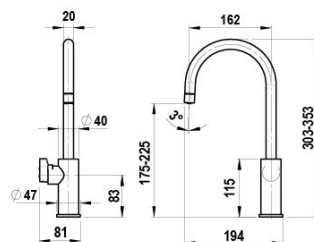

HydroTap Cube Tap

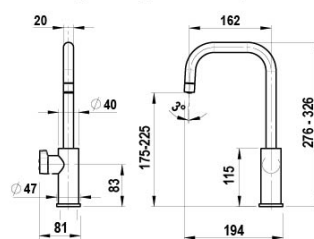

Standalone Font

with Arc Tap

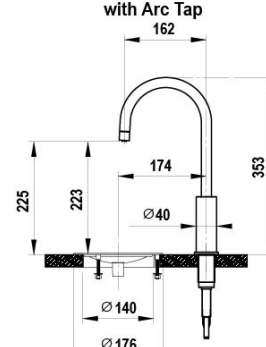

Cutting detail

Technical drawing of the Font 174 headstool. The drawing shows a circular component with a central hole for the bowl (Ø 140) and an outer outline of the Font (Ø 176). There are three off-center holes with a diameter of 10 mm, spaced at 155 mm PCD (Pitch Circle Diameter) and equispaced. The component is designed for a HydroTap Arc/Cube. A dimension of 120° is indicated for the angle between the off-center holes. A separate detail shows a hole for the tap with a diameter of 35 mm.

SCALE 1:5

ALL DIMENSIONS IN MM UNLESS OTHERWISE SPECIFIED. INSTALLATION DIAGRAMS ARE FOR ILLUSTRATIVE PURPOSES ONLY. HOSES ARE NOT SHOWN TO SCALE AND CANNOT BE LENGTHENED.

HydroTap G5 BC Home, BC20

shown with HydroTap Arc

