

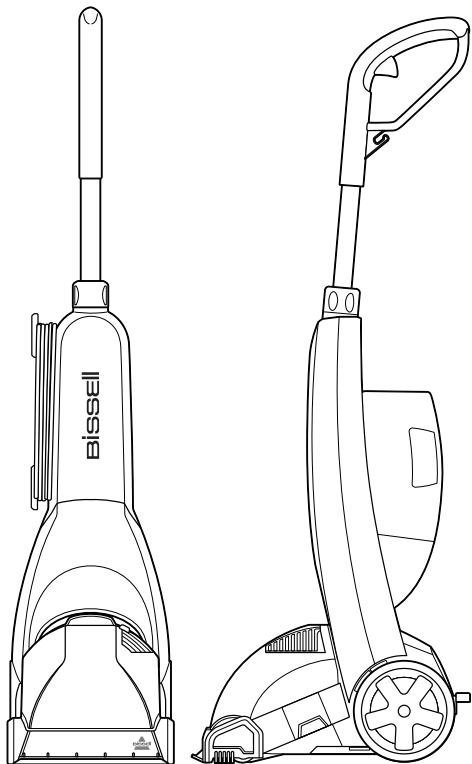

# TURBOCLEAN™ POWERBRUSH Deep Cleaner

USER GUIDE  
2222F



# IMPORTANT SAFETY INSTRUCTIONS

## READ ALL INSTRUCTIONS BEFORE USING YOUR APPLIANCE.

Unplug from outlet when not in use and before conducting maintenance. When using an electrical appliance, basic precautions should be observed, including the following:

### **WARNING**

#### **TO REDUCE THE RISK OF FIRE, ELECTRIC SHOCK, OR INJURY:**

- » This appliance can be used by children aged from 8 years and above and persons with reduced physical, sensory or mental capabilities or lack of experience and knowledge if they have been given supervision or instruction concerning use of the appliance in a safe way and understand the hazards involved. Cleaning and user maintenance shall not be made by children without supervision.
- » Children should be supervised to ensure that they do not play with the appliance.
- » Keep hair, loose clothing, fingers, and all parts of body away from openings and moving parts of the appliance and its accessories.
- » Unplug from electrical socket when not in use, before cleaning, maintaining or servicing the appliance, and if your appliance has an accessory tool with a moving brush, before connecting or disconnecting the tool.
- » If the supply cable is damaged, it must be replaced by the manufacturer, its service agent, or similarly qualified person in order to avoid a hazard.
- » Do not run appliance over cable, a hazard may occur.
- » Do not leave appliance when plugged in.
- » Do not use with damaged cable or plug.
- » Do not pull or carry by cable, use cable as a handle, close door on cable, or pull cable around sharp edges or corners.
- » Keep cable away from heated surfaces.
- » To unplug, grasp the plug, not the cable.
- » Do not handle plug or appliance with wet hands.
- » Turn off all controls before unplugging.
- » Plastic film can be dangerous. To avoid danger of suffocation, keep away from children.
- » Use only as described in this user guide.
- » Use only manufacturer's recommended attachments.
- » Do not immerse in water or liquid.
- » If appliance is not working as it should, has been dropped, damaged, left outdoors, or dropped into water; do not attempt to operate it and have it repaired at an authorized service center.
- » Do not put any object into openings.
- » Do not use with any opening blocked; keep free of dust, lint, hair, and anything that may reduce air flow.
- » Use extra care when cleaning on stairs.
- » Do not use to pick up flammable or combustible liquids, such as petroleum, or use in areas where they may be present.
- » Do not pick up toxic material (chlorine bleach, ammonia, drain cleaner, etc.)
- » Do not use appliance in an enclosed space filled with vapours given off by oil base paint, paint thinner, some mothproofing substances, flammable dust, or other explosive or toxic vapours.
- » Do not pick up hard or sharp objects such as glass, nails, screws, coins, etc.
- » Keep appliance on a level surface.
- » Do not pick up anything that is burning or smoking, such as cigarettes, matches, or hot ashes.
- » Have servicing performed by a qualified repair person using only identical replacement parts. This will ensure that the safety of the product is maintained.
- » Operators shall be adequately instructed on the use of these machines.
- » Always connect to a properly earthed electrical socket. Do not modify earthed plug.
- » Liquid must not be directed towards equipment containing electrical components.
- » Do not immerse. Use only on surfaces moistened by the cleaning process. Use only BISSELL cleaning products intended for use with this machine.
- » Use only the type and amount of liquids specified under the operations section of this guide.
- » Use indoors only.
- » Have servicing performed by a qualified repair person using only identical replacement parts. This will ensure that the safety of the product is maintained.
- » Operators shall be adequately instructed on the use of these machines.

## SAVE THESE INSTRUCTIONS

### **FOR OPERATION ON A 220-240 VOLT A.C. 50-60 HZ POWER SUPPLY ONLY.**

This model is for household use only.

Thanks for buying a BISSELL deep cleaner!

We love to clean and we’re excited to share one of our innovative products with you. We want to make sure your deep cleaner works as well in one year as it does today, so this guide has tips on using (pages 5-9), maintaining (pages 10-13), and if there is a problem, troubleshooting (page 14).

In just a few simple assembly steps, you’ll be ready to deep clean. Flip to page 5 and let’s get started!



What’s In The Box?



Upper Body

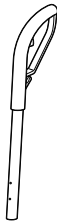

Handle Post

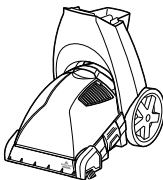

Lower Body



Clean Tank

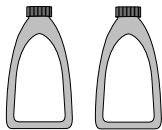

Trial Size Formulas

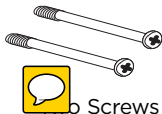

Screws

**NOTE:** Standard accessories may vary by model. To identify what should be included with your purchase, please refer to the “Carton Contents” list located on the carton top flap.

Safety Instructions.....	2	Hard Floor Tool (sold separately) . . . .	13
Product View.....	4	Troubleshooting . . . . .	14
Operations . . . . .	5-9	Guarantee.....	16
Maintenance & Care . . . . .	10-12	Consumer Care.....	16

# Getting to Know Your Deep Cleaner

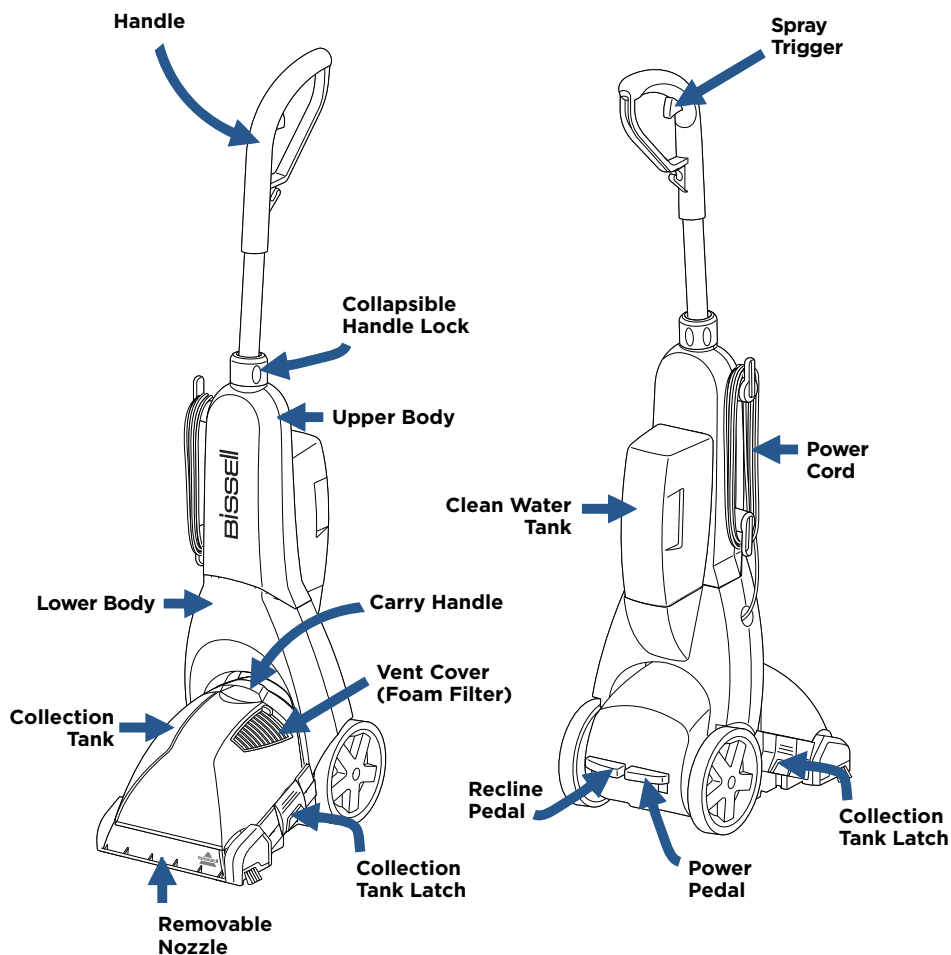

# Assembly

## **WARNING**

Do not plug in your deep cleaner until you are familiar with all instructions and operating procedures.

The only tool you will need to assemble your cleaner is a Phillips screwdriver.



**1**

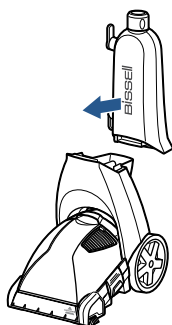

Slide upper body onto lower body.

**2**

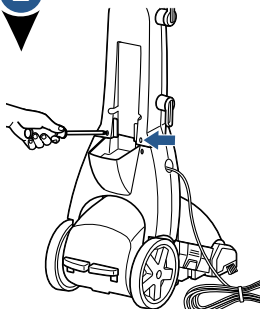

Secure with screws.

**3**

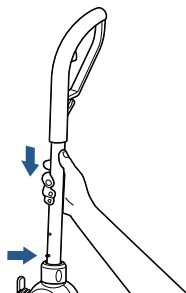

Slide upper Handle Post into the body by aligning the pin and sliding the Post down into place.

**4**

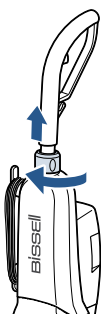

Be sure to secure upper handle before lifting. Rotate lock collar to secure.

**5**

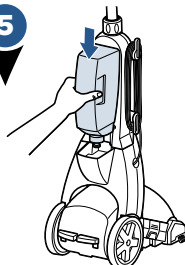

Place Clean Water Tank on back of unit. The tank will make a "CLICK" noise when seated properly.

**6**

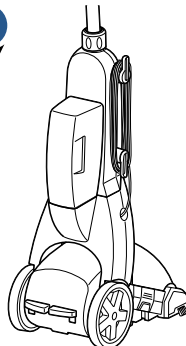

Wrap power cord.

## **Tips Before Carpet Cleaning**

- If cleaning an entire room, consider moving your furniture to another area.
- Remove loose dirt and impediments before cleaning.
- Pre-treat stains with BISSELL PreTreat to improve performance on coffee stains and ground-in dirt.

# Cleaning Formulas

## WARNING







To reduce the risk of fire and electric shock due to internal component damage, use only BISSELL cleaning fluids intended for use with the deep cleaner.

Keep plenty of genuine BISSELL formula on hand so you can clean and protect whenever it fits your schedule.

Always use genuine BISSELL deep cleaning formulas. Non-BISSELL cleaning solutions may harm the machine and may void the guarantee.

**NOTICE:** Use of cleaning formulas which contain lemon, eucalyptus or pine oil may damage this appliance and void the warranty. Chemical spot cleaners or solvent-based soil removers also should not be used. These products may react with the plastic materials used in your cleaner, causing cracking or pitting.

PRETREAT PRETREAT SPOTS AND STAINS TO IMPROVE CARPET CLEANING		BOOST CARPET CLEANING FORMULA ENHANCER
		
Stain PreTreat	Pet Stain PreTreat	Oxy Boost
Pretreat to penetrate and loosen tough stains	Pretreat to help remove tough pet stains and odours	Removes old, set-in stains permanently

2X* CONCENTRATED CLEANING FORMULAS						
WASH & PROTECT			WASH & REMOVE	WASH & REFRESH		WASH & SHINE
						
Professional Stain & Odour	Pet Stain & Odour	Stain & Odour	Allergen Removal	Ambipur™ Blossom & Breeze	Natural Orange	Hard Floor
Professional strength to remove extra tough stains and odours <i>Includes Scotchgard™ Protector</i>	Removes tough pet stains and contains odour removal technology <i>Includes Scotchgard™ Protector</i>	Removes tough stains and odours <i>Includes Scotchgard™ Protector</i>	Helps remove allergens like pet, pollen and dust mite waste	Powerful cleaning with a refreshing spring scent	Powerful cleaning with a refreshing natural orange scent	Removes tough dirt and grime and leaves a natural shine

ONLY BISSELL Wash & Protect formulas protect from future stains with Scotchgard™ Protector. Scotchgard™ is a trademark of 3M®.

\*60 mL of 2X concentrated formula is equivalent to 120 mL of non-concentrated formula.

# Fill Clean Water Tank

1

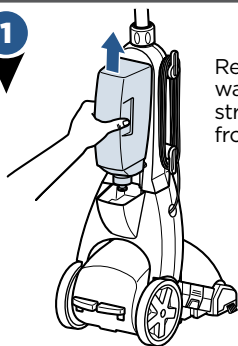

Remove the clean water tank lifting straight up and away from lower body.

2

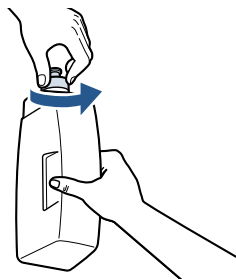

Unscrew the cap at the bottom of the clean water tank.

3

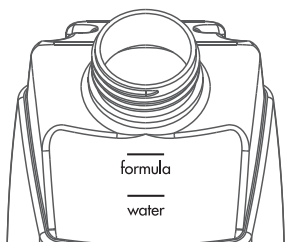

Fill with warm tap water to the WATER line. Fill the rest of the tank with BISSELL Formula to the FORMULA line.

4



Replace and tighten the cap, then return the clean water tank to lower body. The tank will make a "CLICK" noise when seated properly.

## A few notes about filling the clean water tank:

- Fill with hand hot (140°F/60°C MAX) tap water and add the appropriate BISSELL solution. **DO NOT USE BOILING WATER. DO NOT HEAT WATER OR TANK IN MICROWAVE.**

**NOTICE:** Do not over wet carpet. Be careful not to run over loose objects or edges of area rugs. Stalling the brush may result in premature belt failure.

**NOTE:** Do not substitute BISSELL Formula cleaning solution with other household cleaning products.



## Pour in more power with BISSELL OXY Boost

- Fill tank with water and BISSELL cleaning formula.
- Add 29.5 ml of BISSELL OXY Boost per 1.89 Liter of water.
- TurboClean PowerBrush has a 1.89 Liter tank.

# Cleaning Your Carpet

**Important!** Please check manufacturer's tag before cleaning area rugs for any specialized cleaning instructions. We do not recommend deep cleaning delicate, silk, wool, antique or area rugs without a manufacturer's tag.

1

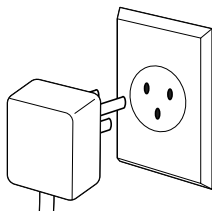

Plug into a proper outlet.

2

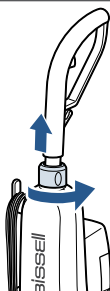

Extend the Collapsible Handle Post by turning the collar counterclockwise and lifting the handle up. Turn the collar clockwise to secure.

**IMPORTANT BEFORE USE:** Make sure the handle post is fully extended up and the collar lines up with the lock symbol before you begin cleaning.

3

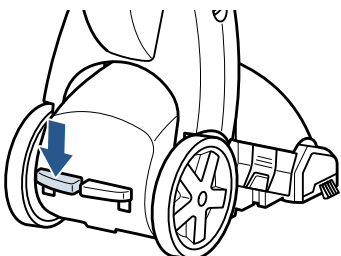

With foot, press the grey recline lever located next to power button.

4

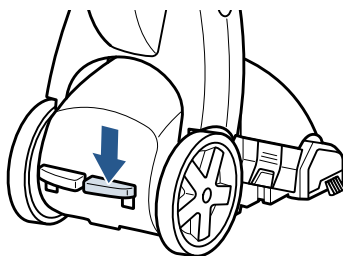

With foot, press the red power button, located on the back of the machine.

5



## Cleaning Pass:

1. While pressing the trigger, make one slow forward wet pass and another one back.
2. Release the trigger and make one slow forward and backward pass over the same area.
3. Repeat steps 1 and 2 until solution being pulled up appears clean.
4. Empty the collection tank when dirty water reaches the full line, and fill with fresh warm water and formula when the Clean Water Tank is empty.



# Empty Collection Tank

## WARNING

To reduce the risk of fire, electric shock or injury, turn power OFF and disconnect plug from electrical outlet before performing maintenance or troubleshooting.

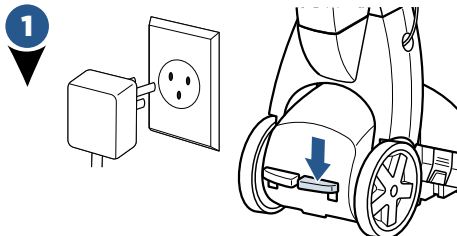

With foot, press the red power button, to turn off unit and then unplug.

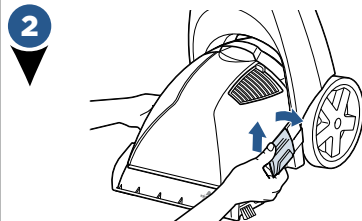

Release Collection Tank latches (on each side) by pulling up from the bottom of latch and then out.

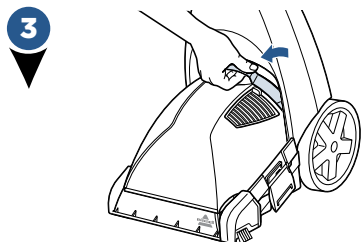

Carefully remove tank by lifting up on the tank carry handle.

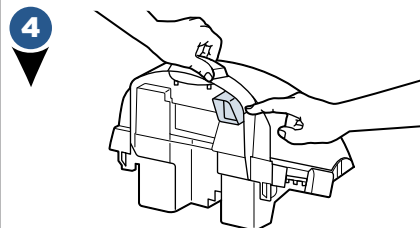

Carry the Collection Tank to a sink. To empty, tilt tank and pour out contents using the opening at the back of tank.

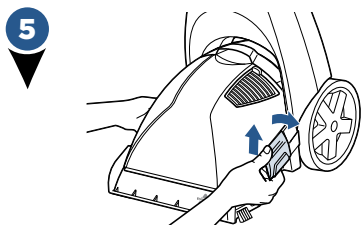

Rinse the Collection Tank thoroughly and replace on unit. Secure latches on both sides of the tank.

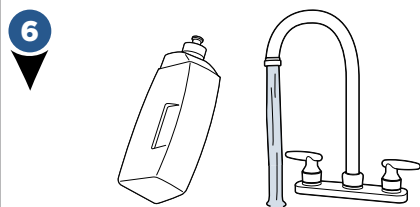

Refill the Clean Water Tank and continue cleaning or if you're done cleaning, wait for the pieces to dry before storing your machine.

# Cleaning Machine After Use

## **WARNING**

To reduce the risk of electric shock, turn power switch OFF and disconnect plug from electrical outlet before performing maintenance or troubleshooting checks.

1

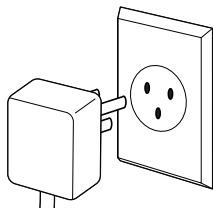

Unplug the unit.

2

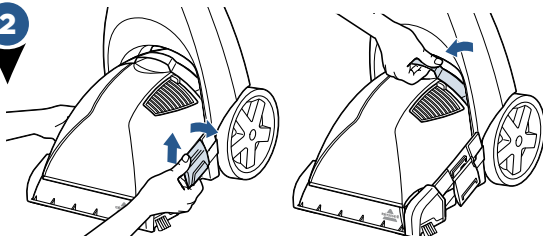

Remove and rinse the Collection Tank thoroughly.

3

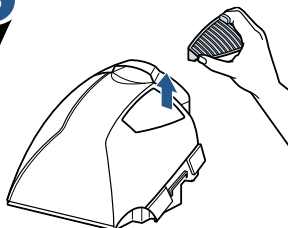

Remove tank vent & foam filter (located on top of the Collection Tank) and rinse.

4

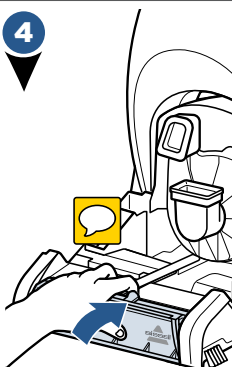

To remove and clean the nozzle, keep the Collection Tank off of the unit.

Gently pull the two tabs that point up near the front of the unit. The nozzle will unhook to remove. Rinse under running water. When finished, slightly tilt the machine so the foot raises up so you can align the nozzle hooks at the floor of the unit. Rotate the nozzle up to clip back into place.

5

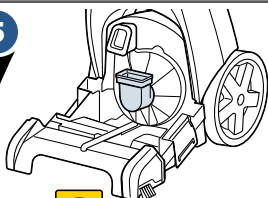

Remove lint and hair from red gasket in base of unit. (Do not remove gasket)

6

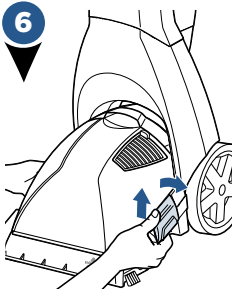

Once the parts have been rinsed clean and dried, replace the Collection Tank to the base of the machine and secure with both latches. Wrap power cord around Quick Release Cord Wrap™ on side of the machine. Wipe all surfaces with a soft cloth and store cleaner upright in a protected, dry area.

**NOTICE:** To reduce the risk of a leaking condition, do not store unit where freezing may occur. Damage to internal components may result.

# Replacing Belts & Brush Rolls

## **WARNING**

To reduce the risk of electric shock, turn power switch OFF and disconnect plug from electrical outlet before performing maintenance or troubleshooting checks.

**What you will need: 1 Phillips screwdriver & 1 flathead screwdriver**

**1**

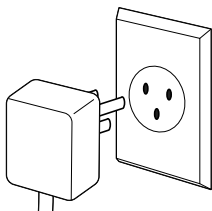

Turn the machine off and unplug from wall outlet.

**2**

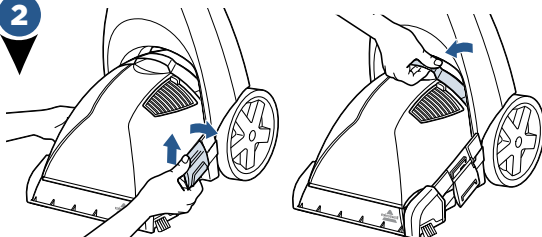

Remove the Clean Water and Collection Tanks.

**3**

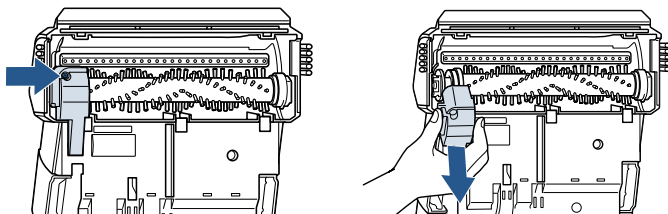

Lay machine down to access the bottom of the machine. With a Phillips head screwdriver, unscrew the belt cover and remove.

**4**

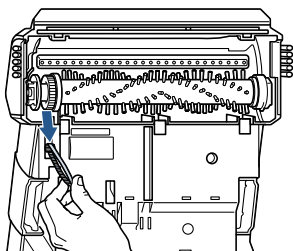

If you want to replace or clean the brush roll, remove the belt by slightly lifting the brush roll to maneuver the belt and remove it. If the belt is broken and needs to be replaced, remove it and replace with a new belt.

**5**

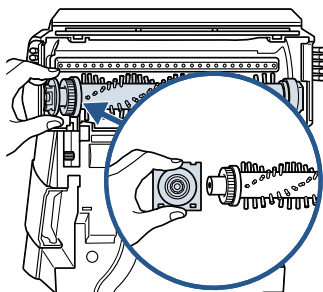

When removing the brush roll, the brush roll cap will come with it. Do not lose this part.

## Replacing Belts & Brush Rolls (continued)

7

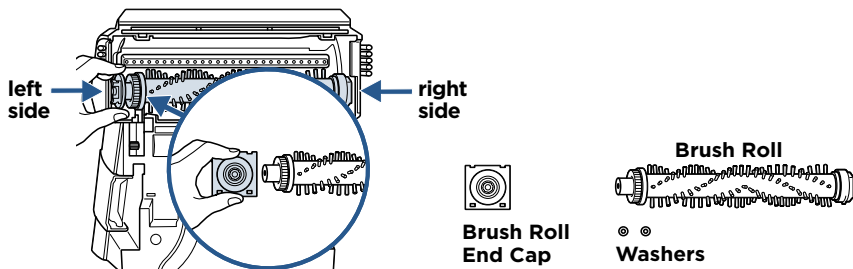

Clean or replace the brush roll and belt. When finished cleaning these parts, reassemble them to the machine.

Insert the brush into the right side end cap. Adjust the right side of the brush into place and tuck the left brush roll cap (separate piece that attaches to brush roll) into place.

8

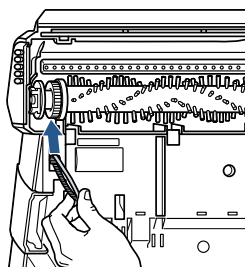

Maneuver the belt to wrap around the pulley. Wrap the belt around the cog of the brush roll. Secure the brush roll into place by sliding the square piece to align the brush roll.

9

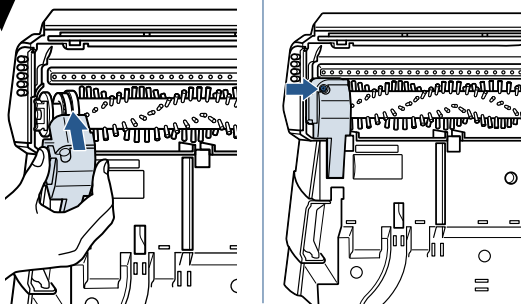

Reattach belt cover and screw into place.

**NOTE:** Manually rotate brush to make sure it rotates freely and the belt is aligned.

## HARD FLOOR TOOL SOLD SEPARATELY

### Hard Floor Cleaning (select models only)

1

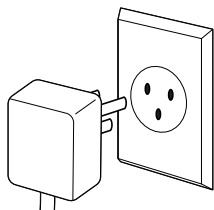

With foot, press the red power button, to turn off unit and then unplug.

2

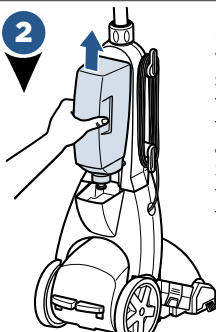

Remove the clean water tank lifting straight up and away from lower body. Fill the tank using water and BISSELL Wash & Shine Floor Cleaner formula for cleaning the hard floor.

3

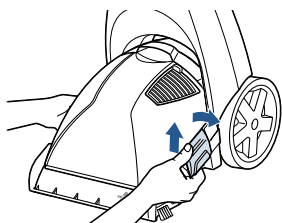

Release Collection Tank latches (on each side) by pulling up from the bottom of latch and then out.

4

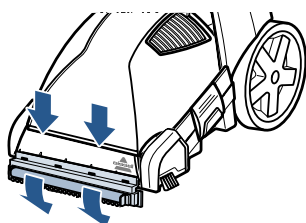

Attach the hard floor tool by hooking it into the front of the nozzle. Rotate down until it snaps into place.

5

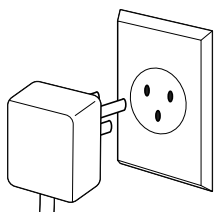

Return both tanks to the machine and plug into a proper outlet.

6

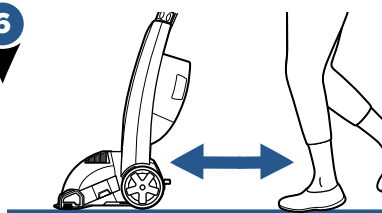

Follow the "Cleaning Pass" instructions on the previous page (page 8, step 5).

## WARNING

To reduce the risk of fire and electric shock when cleaning a hard floor, the BISSELL hard floor tool must be used and it must only be used with BISSELL Wash & Shine Floor Cleaner intended for use with this appliance.

# Troubleshooting



## **WARNING**

To reduce the risk of electric shock, turn power switch OFF and disconnect plug from electrical outlet before performing maintenance or troubleshooting checks.

Problem	Possible causes	Remedies
<b>Reduced spray OR no spray</b>	Clean Water Tank is empty.	Refill tank with water and formula.
	Lint screen on Clean Water Tank cap clogged.	Soak Clean Water Tank cap in warm water and then rinse under running water.
	Spray nozzle clogged.	Clean spray nozzle by rinsing under water.
	Upper handle is not in the upright and locked position.	Rotate the retractable handle lock, pull handle up and return the handle lock to the locked position
	Clean Tank not properly seated on unit.	Remove Clean Tank, ensure cap is tightened properly, and reinstall Clean Tank until a 'click' sound is heard.
	Upper handle assembly not fully installed.	Unscrew and reassemble upper handle body to lower base. Ensure trigger on handle has tension. 
<b>Deep cleaner not picking up cleaning solution</b>	Collection Tank is not aligned/secured.	Check tank alignment and secure with side latches.
	Collection Tank is full.	Empty tank.
	Removable nozzle installed improperly.	Unplug unit and align two "hooks" into bottom first, then snap into place on top.
	Removable nozzle full of debris.	Unplug unit, remove nozzle and rinse under running water.
	Red lint screen under Collection Tank is clogged.	Remove debris from lint screen.

# Notes

# Consumer Guarantee

This Guarantee only applies outside of the USA and Canada. It is provided by BISSELL International Trading Company BV ("BISSELL").

This Guarantee is provided by BISSELL. It gives you specific rights. It is offered as an additional benefit to your rights under law. You also have other rights under law which may vary from country to country. You can find out about your legal rights and remedies by contacting your local consumer advice service. Nothing in this Guarantee will replace or lessen any of your legal rights or remedies. If you need additional instruction regarding this Guarantee or have questions regarding what it may cover, please contact BISSELL Consumer Care or contact your local distributor.

This Guarantee is given to the original purchaser of the product from new and is not transferable. You must be able to evidence the date of purchase in order to claim under this Guarantee.

## Limited 2 Year Guarantee (from the date of purchase by original purchaser)

Subject to the \*EXCEPTIONS AND EXCLUSIONS identified below, BISSELL will repair or replace (with new or remanufactured components or products), at BISSELL's option, free of charge, any defective or malfunctioning part or product.

BISSELL recommends that the original packaging and evidence of the date of purchase be kept for the duration of the Guarantee period in case the need arises within the period to claim on the Guarantee. Keeping the original packaging will assist with any necessary re-packaging and transportation but is not a condition of the Guarantee.

If your product is replaced by BISSELL under this Guarantee, the new item will benefit from the remainder of the term of this Guarantee (calculated from the date of the original purchase). The period of this Guarantee shall not be extended whether or not your product is repaired or replaced.

### \*EXCEPTIONS AND EXCLUSIONS FROM THE TERMS OF THE GUARANTEE

This Guarantee applies to products used for personal domestic use and not commercial or hire purposes. Consumable components such as filters, belts and mop pads, which must be replaced or serviced by the user from time to time, are not covered by this Guarantee.

This Guarantee does not apply to any defect arising from fair wear and tear. Damage or malfunction caused by the user or any third party whether as a result of accident, negligence, abuse, neglect, or any other use not in accordance with the User Guide is not covered by this Guarantee.

An unauthorised repair (or attempted repair) may void this Guarantee whether or not damage has been caused by that repair/attempt.

Removing or tampering with the Product Rating Label on the product or rendering it illegible will void this Guarantee.

SAVE AS SET OUT BELOW BISSELL AND ITS DISTRIBUTORS ARE NOT LIABLE FOR ANY LOSS OR DAMAGE THAT IS NOT FORESEEABLE OR FOR INCIDENTAL OR CONSEQUENTIAL DAMAGES OF ANY NATURE ASSOCIATED WITH THE USE OF THIS PRODUCT INCLUDING WITHOUT LIMITATION LOSS OF PROFIT, LOSS OF BUSINESS, BUSINESS INTERRUPTION, LOSS OF OPPORTUNITY, DISTRESS, INCONVENIENCE OR DISAPPOINTMENT. SAVE AS SET OUT BELOW BISSELL'S LIABILITY WILL NOT EXCEED THE PURCHASE PRICE OF THE PRODUCT.

BISSELL DOES NOT EXCLUDE OR LIMIT IN ANY WAY ITS LIABILITY FOR (A) DEATH OR PERSONAL INJURY CAUSED BY OUR NEGLIGENCE OR THE NEGLIGENCE OF OUR EMPLOYEES, AGENTS OR SUBCONTRACTORS; (B) FRAUD OR FRAUDULENT MISREPRESENTATION; (C) OR FOR ANY OTHER MATTER WHICH CANNOT BE EXCLUDED OR LIMITED UNDER LAW.

## Consumer Care

**If your BISSELL product should  
require service or to claim under our  
limited guarantee, please contact us  
as follows:**

### Website and Email:

[www.bissell.com.au](http://www.bissell.com.au)

[www.bissell.co.nz](http://www.bissell.co.nz)

### Telephone:

Australia: 1300-247-735

New Zealand: 0800-247-735

### Write:

BISSELL AUSTRALIA PTY LIMITED

42 Rocco Dr.

Scoresby 3179

Victoria

Australia

## Visit the BISSELL website: [www.BISSELL.com](http://www.BISSELL.com)

When contacting BISSELL, have model number of cleaner available.

Please record your Model Number: \_\_\_\_\_ Please record your Purchase Date: \_\_\_\_\_

**NOTE: Please keep your original sales receipt. It provides proof of the date of purchase in the event of a Guarantee claim. See Guarantee for details.**



©2017 BISSELL Homecare, Inc.  
Grand Rapids, Michigan  
All rights reserved. Printed in China  
Part Number 161-2998 11/17 RevB  
Visit our website at: [www.BISSELL.com](http://www.BISSELL.com)